

CONSTRUCTION DOCUMENTS

# 2022 BOND - PAINTING PROJECT DISTRICTWIDE

## PACKAGE A CSP No. 26P-040LP

PASADENA INDEPENDENT SCHOOL DISTRICT  
3920 Mickey Gilley Boulevard  
Pasadena, Texas 77505

29 April 2026

PACKAGE A CAMPUSES

**Sullivan Middle School**  
1112 Queens Road  
Pasadena, Texas 77502

**The Summit**  
1838 East Sam Houston Parkway South  
Pasadena, Texas 77503

**De Zavala Middle School**  
101 Jackson Avenue  
Pasadena, Texas 77506

**Jackson Intermediate School**  
1020 Thomas Avenue  
Pasadena, Texas 77506

**Bobby Shaw Middle School**  
1201 Houston Avenue  
Pasadena, Texas 77502

**Southmore Intermediate School**  
2000 Patricia Lane  
Pasadena, Texas 7750

**South Houston High School**  
3820 Shaver Street  
Pasadena, Texas 77587

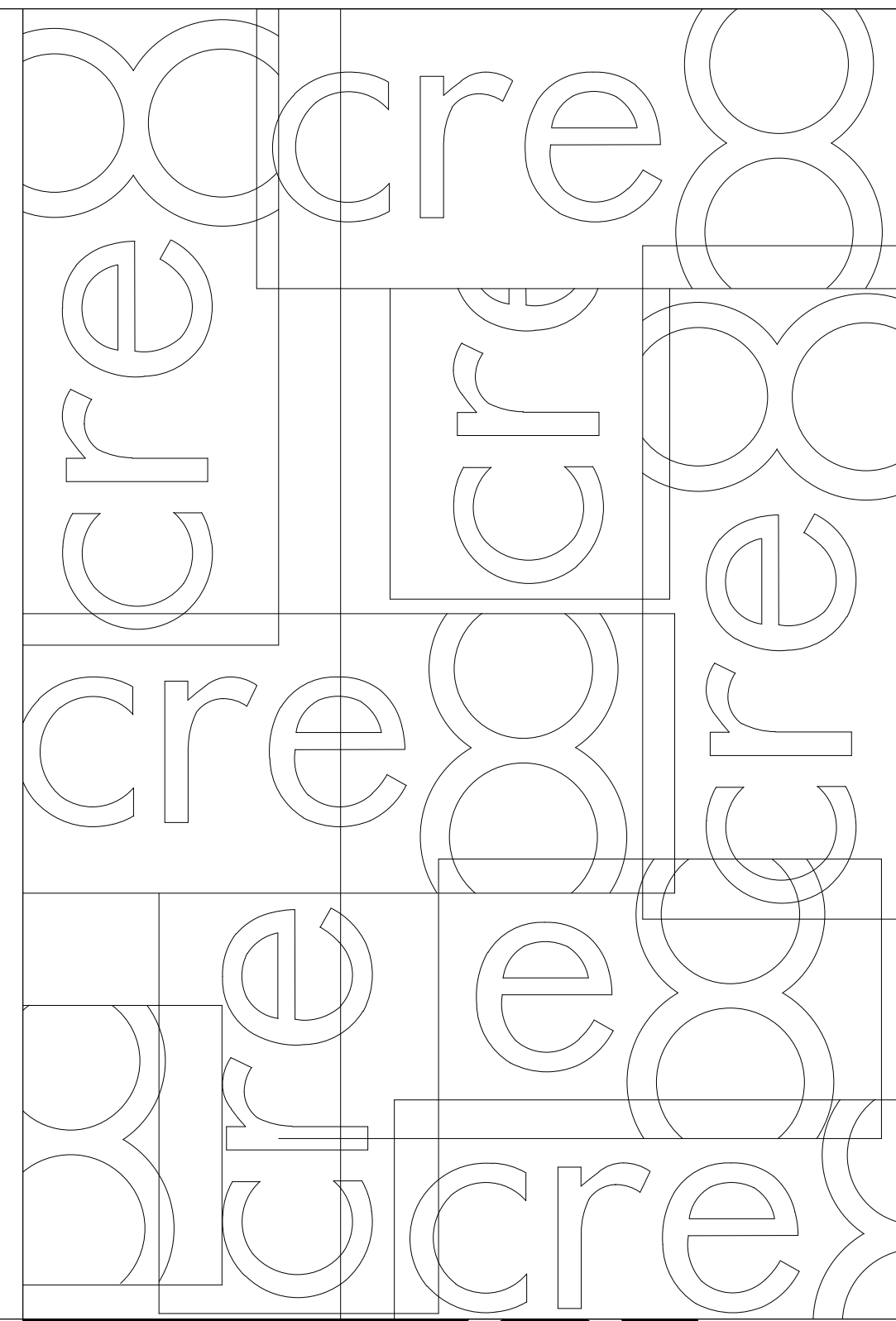

ARCHITECT

3815 Montrose Boulevard  
Suite 123  
Houston, Texas 77006  
713.526.cre8 (2738)  
713.526.3198 fax

INDEX OF DRAWINGS - PACKAGE A	
Sheet Number	Sheet Name

00 GENERAL SHEETS

A0.00	COVERSHEET - PACKAGE A
-------	------------------------

01 PACKAGE A

A1	SULLIVAN MIDDLE SCHOOL
A2	THE SUMMIT
A3	DE ZAVALA MIDDLE SCHOOL
A4	JACKSON INTERMEDIATE SCHOOL
A5	BOBBY SHAW MIDDLE SCHOOL
A6	SOUTHMORE INTERMEDIATE SCHOOL - LEVEL 1
A6.1	SOUTHMORE INTERMEDIATE SCHOOL - LEVEL 2
A7	SOUTH HOUSTON HIGH SCHOOL - LEVEL 1
A7.1	SOUTH HOUSTON HIGH SCHOOL - LEVEL 2

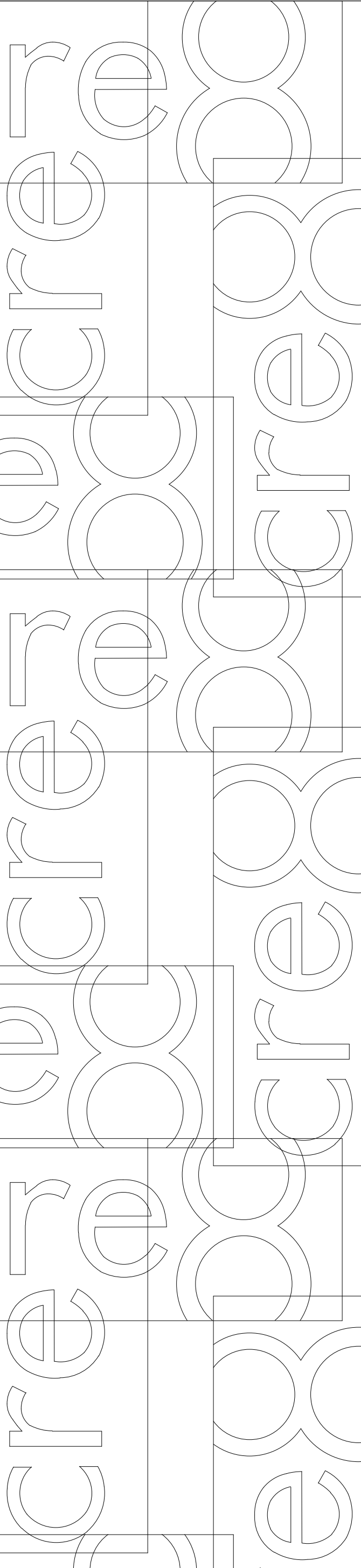



TYPICAL WALL DAMAGE @ CLASSROOM WALLS

REPAIR WALL AND PROVIDE WALL PROTECTION WP-1 PER DETAIL 3A1 TYPICAL AT ALL CLASSROOM WALLS

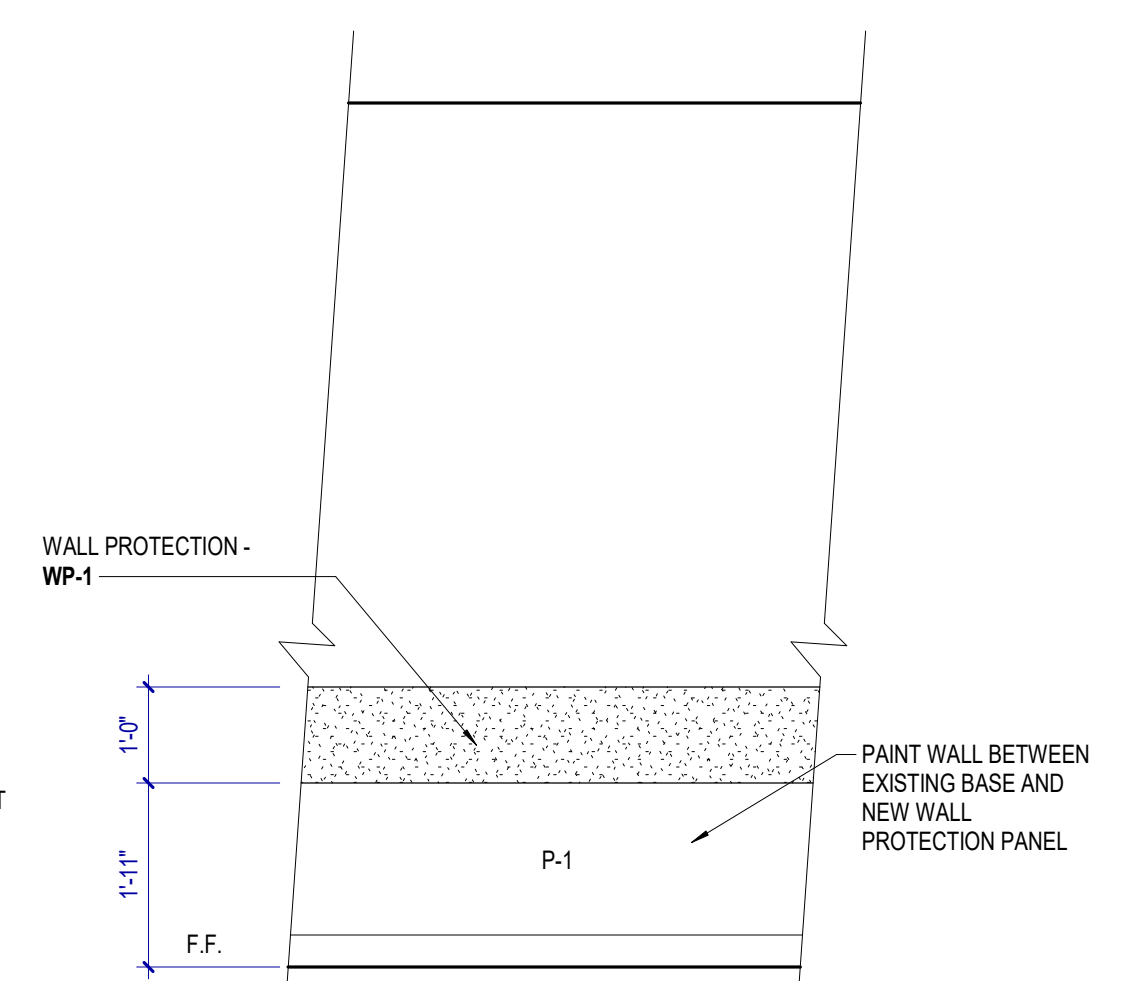

1. TYPICAL AT ALL CLASSROOM WALLS.
2. VERIFY CLASSROOM WALLS IN FIELD FOR REQUIRED LENGTH OF WALL PROTECTION PAINT BETWEEN EXISTING BASE AND NEW WALL PROTECTION PANEL.

3 TYPICAL WALL PROTECTION ELEVATION 1/2" = 1'-0"

NOTES TO FINISH/COLOR SCHEDULE

- GENERAL NOTES
1. ALL NOTES ON THIS SHEET MAY NOT NECESSARILY BE USED.
  2. MANUFACTURER'S NAME AND IDENTIFICATION NUMBERS ARE LISTED AS A MEANS OF ESTABLISHING A STANDARD OF TYPE, FUNCTION, COLOR AND QUALITY. REFER TO SPECIFICATIONS FOR ADDITIONAL MANUFACTURERS AND PROCEDURES. ANY APPROVED MANUFACTURER'S COLORS SHALL MATCH THOSE LISTED IN THE COLOR SCHEDULE.
  3. THE CONTRACTOR SHALL SUBMIT TO THE ARCHITECT A SAMPLE OF ALL FINISH MATERIALS FOR APPROVAL BEFORE MATERIALS ARE APPLIED ON THE JOB.

- PAINTING AND STAINING NOTES
1. ALL PAINTS SHALL BE EGGSHELL FINISH, UNLESS NOTED OTHERWISE.
  2. PAINT A MINIMUM OF 6'-0" X 6'-0" OF EACH PAINT COLOR AT PROJECT SITE FOR OWNER/ARCHITECT APPROVAL PRIOR TO APPLICATION.
  3. UNLESS NOTED OTHERWISE, TERMINATE ALL ACCENT PAINTS AT INSIDE CORNERS.
  4. UNLESS NOTED OTHERWISE, PAINT ANY VENTS, GRILLES, FIRE EXTINGUISHER CABINETS, ETC. THE SAME COLOR AS THE WALL SURFACE ON WHICH THEY OCCUR.
  5. UNLESS NOTED OTHERWISE, PAINT ALL VISION PANEL FRAMES IN INTERIOR DOORS TO MATCH FRAME COLOR.
  7. ACCESS PANELS SHALL BE PAINTED THE SAME COLOR AS THE ADJACENT SURFACE ON WHICH THEY OCCUR.

P - PAINT			
TYPE	MARK	MANUFACTURER	COLOR
FIELD (WALL)	P-1	SHERWIN WILLIAMS	MATCH EXISTING

WP - WALL PROTECTION				
TYPE	MARK	MANUFACTURER	SIZE	COLOR
WP-1		ACROVYN RUBSTRIPS	12" TALL	OYSTER GRAY #629

- SCOPE OF WORK
- THE SCOPE OF WORK FOR THIS CAMPUS INCLUDES THE FOLLOWING:
- REPAIR, PREPARATION AND PAINT EXISTING DAMAGED DRYWALL @ SIDE WALLS AND EXTERIOR WALL IN CLASSROOMS (SHOWN IN BLUE)
  - WALL PROTECTION TO BE CONTINUOUS AROUND COLUMN ENCLOSURES, ETC. AT ALL EXTERIOR WALL AND TWO SIDE WALLS, TYP (SHOWN IN BLUE)
  - RELOCATION OF MOVEABLE FURNISHINGS AND EQUIPMENT WITHIN ANY SPACE TO RECEIVE WALL PROTECTION
  - PROVIDE COMPLETE MOCK-UP INSTALLATION AT ONE CLASSROOM FOR OWNER/ARCHITECT REVIEW PRIOR TO INSTALLATION AT ALL ROOM LOCATIONS.

GENERAL NOTES

1. MATCH EXISTING PAINT COLORS AT ALL LOCATIONS UNLESS NOTED OTHERWISE.
2. PAINT WALLS TO INSIDE CORNERS.
3. UNLESS NOTE OTHERWISE, PAINT ANY VENTS, GRILLES, ETC. THE SAME COLOR AS THE WALL SURFACE ON WHICH THEY OCCUR.
4. ACCESS PANELS SHALL BE PAINTED THE SAME COLOR AS THE ADJACENT SURFACE ON WHICH THE OCCUR.
5. CONTRACTOR TO FIELD VERIFY EXISTING CEILING HEIGHTS.
6. CONTRACTOR SHALL RELOCATE ROOM FURNISHINGS AND EQUIPMENT, STORE AND OTHER ITEMS NOT PERMANENTLY INSTALLED AS REQUIRED FOR EXECUTION OF THE SCOPE OF WORK.



Copyright © 2003 cre8 architects  
This document and the ideas and designs incorporated herein, as an instrument of professional service, is the property of cre8 architects and is not to be used, in whole or in part, for any project without the written authorization of cre8 architects.

2022 BOND - PAINTING PROJECT  
DISTRICTWIDE  
3920 Mickey Gilley Boulevard  
Pasadena, Texas 77505  
PASADENA INDEPENDENT SCHOOL DISTRICT

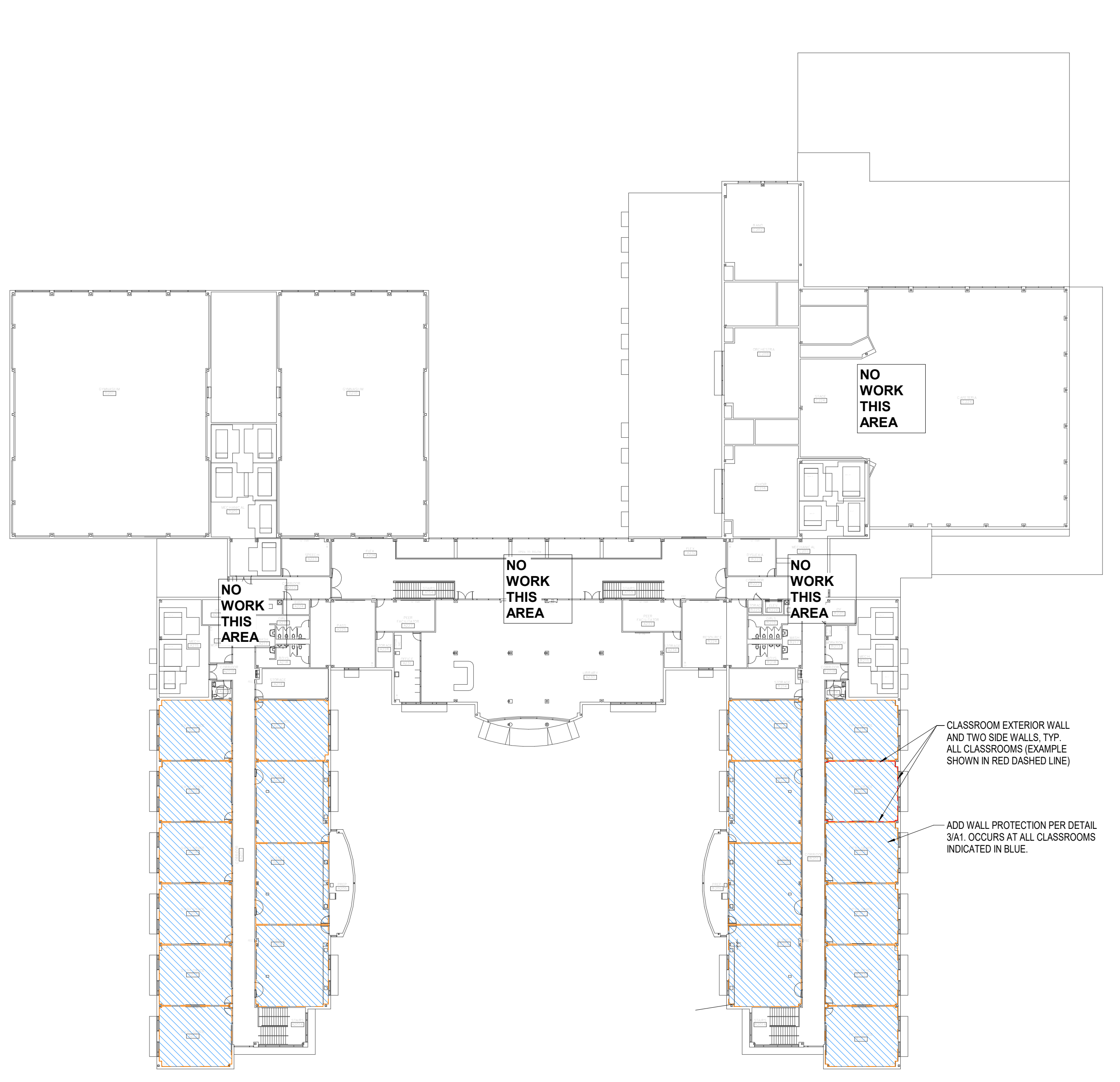

2 SULLIVAN MIDDLE SCHOOL - SECOND FLOOR 1/32" = 1'-0"

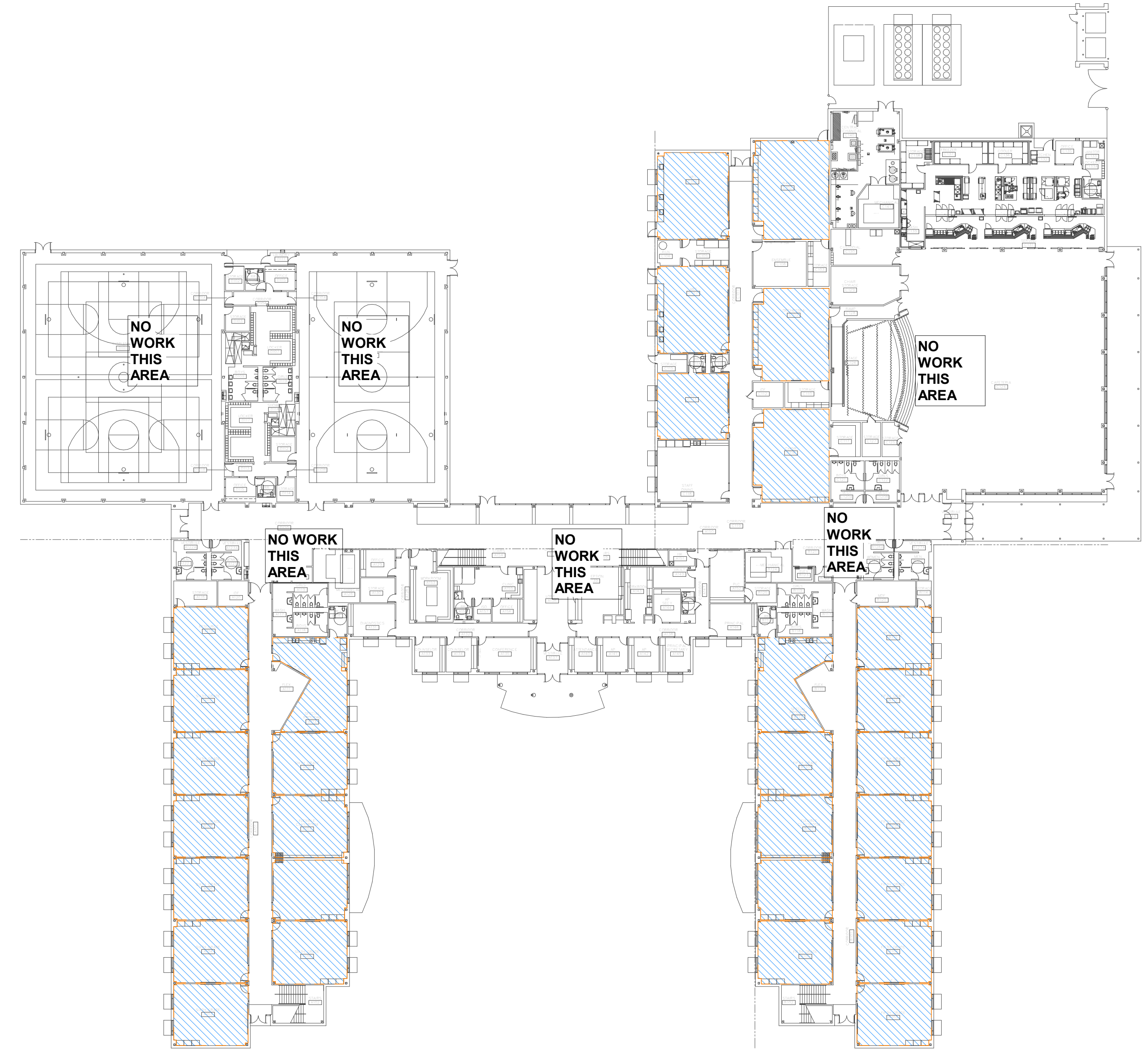

1 Sullivan Middle School - First Floor 1/32" = 1'-0"

LEGEND



INDICATES AREA OF WORK



Revision Schedule		
NO.	ISSUE	DATE

Sheet Information	
Date	29 April 2026
Job Number	25-007.2
Drawn	Author
Checked	Checker
Approved	Approver
	Title

SULLIVAN MIDDLE SCHOOL

Sheet  
A1

BINDING EDGE

BINDING EDGE

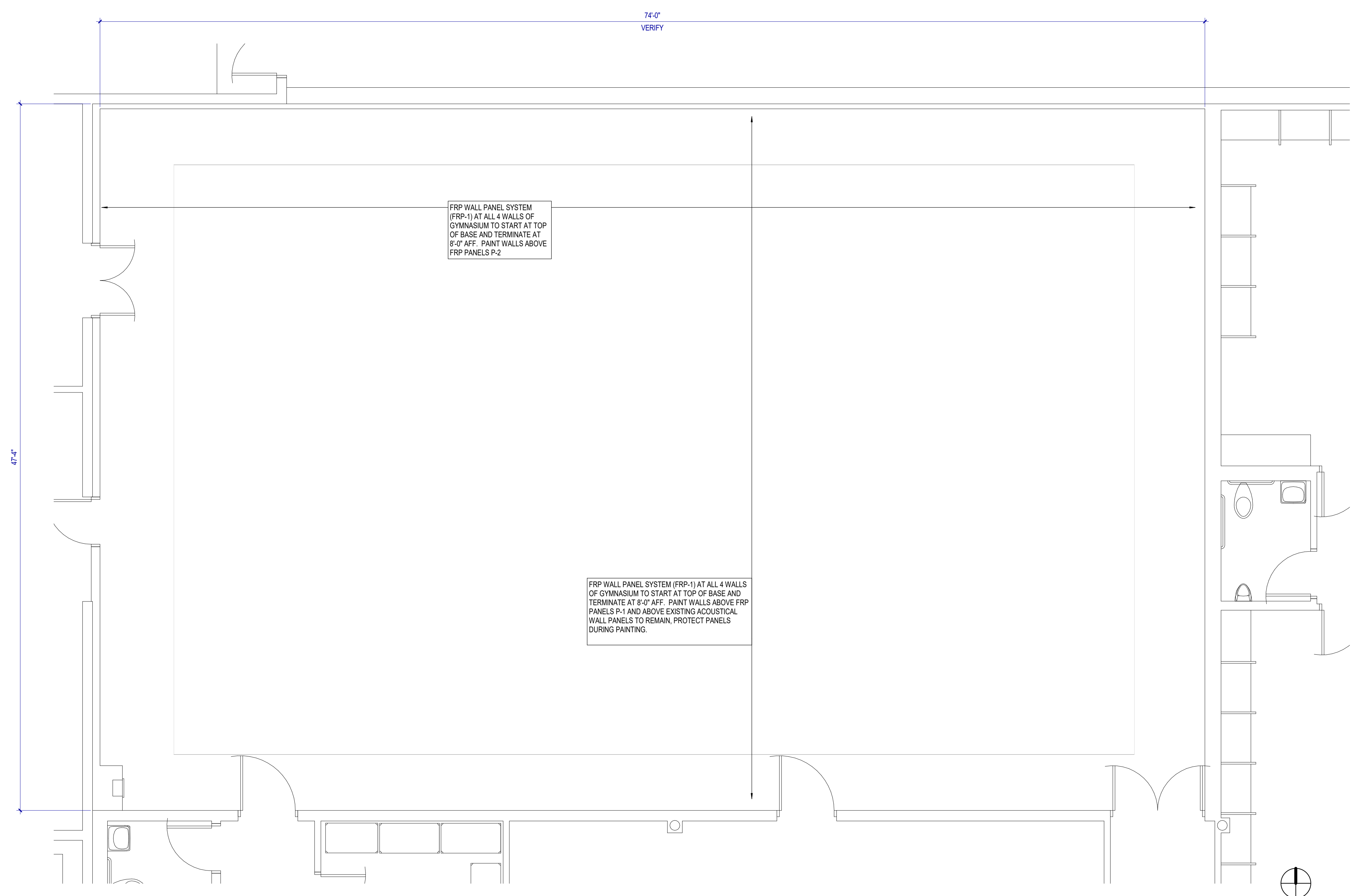

2 ENLARGED PLAN - GYMNASIUM  
1/4" = 1'-0"

### NOTES TO FINISH/COLOR SCHEDULE

- GENERAL NOTES**
- ALL NOTES ON THIS SHEET MAY NOT NECESSARILY BE USED.
  - MANUFACTURER'S NAME AND IDENTIFICATION NUMBERS ARE LISTED AS A MEANS OF ESTABLISHING A STANDARD OF TYPE, FUNCTION, COLOR AND QUALITY. REFER TO SPECIFICATIONS FOR ADDITIONAL MANUFACTURERS AND PROCEDURES. ANY APPROVED MANUFACTURER'S COLORS SHALL MATCH THOSE LISTED IN THE COLOR SCHEDULE.
  - THE CONTRACTOR SHALL SUBMIT TO THE ARCHITECT A SAMPLE OF ALL FINISH MATERIALS FOR APPROVAL BEFORE MATERIALS ARE APPLIED ON THE JOB.
  - REFER TO INTERIOR ELEVATIONS FOR ADDITIONAL INFORMATION CONCERNING FINISH MATERIALS AND COLORS.
  - REFER TO FLOOR PATTERN LAYOUTS FOR FLOOR/COLOR SELECTIONS. TRANSITION OF FLOOR FINISH MATERIALS SHALL OCCUR ON THE CENTERLINE OF DOOR.

- PAINTING AND STAINING NOTES**
- ALL PAINTS SHALL BE EGGSHELL FINISH, UNLESS NOTED OTHERWISE.
  - PAINT A MINIMUM OF 8'-0" X 8'-0" OF EACH PAINT COLOR AT PROJECT SITE FOR OWNER/ARCHITECT APPROVAL PRIOR TO APPLICATION.
  - UNLESS NOTED OTHERWISE, TERMINATE ALL ACCENT PAINTS AT INSIDE CORNERS.
  - UNLESS NOTED OTHERWISE, PAINT ANY VENTS, GRILLES, FIRE EXTINGUISHER CABINETS, ETC. THE SAME COLOR AS THE WALL SURFACE ON WHICH THEY OCCUR.
  - UNLESS NOTED OTHERWISE, PAINT ALL VISION PANEL FRAMES IN INTERIOR DOORS TO MATCH FRAME COLOR.
  - PROVIDE ALL NECESSARY TRIM PIECES FOR FIBERGLASS REINFORCED PANELS.
  - ACCESS PANELS SHALL BE PAINTED THE SAME COLOR AS THE ADJACENT SURFACE ON WHICH THEY OCCUR.
  - UNLESS NOTED OTHERWISE, PAINT INTERIOR HM DOOR FRAMES P-3.

**P - PAINT**

TYPE	MARK	MANUFACTURER	COLOR
FIELD (WALL)	P-1	SHERWIN WILLIAMS	MATCH EXISTING
ACCENT	P-2	SHERWIN WILLIAMS	MATCH EXISTING
HM FRAME	P-3	SHERWIN WILLIAMS	MATCH EXISTING

**FRP - FIBERGLASS REINFORCED PANEL**

TYPE	MARK	MANUFACTURER	SIZE	COLOR
GYM WALLS	FRP-1	MARLITE ARTIZAN MIDIAN	4'X8'	MAX STEAM

### SCOPE OF WORK

- THE SCOPE OF WORK FOR THIS CAMPUS INCLUDES THE FOLLOWING:
- REPAIR EXISTING DAMAGED DRYWALL @ PERIMETER OF GYMNASIUM
  - REPAIRATION OF WALL SURFACE AND INSTALL FIBERGLASS REINFORCED PANELS (FRP-1) 8'-0" TALL AT PERIMETER WALL OF GYMNASIUM ABOVE 4' EXISTING BASE.
  - WALL PANELS TO BE CONTINUOUS AROUND COLUMN ENCLOSURES, ETC. AT ALL WALL LOCATED INDICATED.
  - PAINT DRYWALL SURFACES ABOVE NEW PANEL SYSTEM AND EXISTING ACoustICAL WALL PANELS. PROTECT WALL PANELS.
  - PAINT ALL HOLLOW METAL DOOR AND WINDOW FRAMES.
  - RELOCATION OF MOVEABLE FURNISHINGS AND EQUIPMENT WITHIN ANY SPACE TO RECEIVE WALL PROTECTION

### GENERAL NOTES

- MATCH EXISTING PAINT COLORS AT ALL LOCATIONS UNLESS NOTED OTHERWISE.
- PAINT WALLS TO INSIDE CORNERS.
- UNLESS NOTED OTHERWISE, TERMINATE ALL ACCENT PAINTS AT INSIDE CORNERS.
- UNLESS NOTE OTHERWISE, PAINT ANY VENTS, GRILLES, ETC. THE SAME COLOR AS THE WALL SURFACE ON WHICH THEY OCCUR.
- ACCESS PANELS SHALL BE PAINTED THE SAME COLOR AS THE ADJACENT SURFACE ON WHICH THEY OCCUR.
- CONTRACTOR TO FIELD VERIFY EXISTING CEILING HEIGHTS.
- PAINT ALL EXISTING HOLLOW METAL FRAMES.
- CONTRACTOR SHALL RELOCATE ROOM FURNISHINGS AND EQUIPMENT, STORE, AND OTHER ITEMS NOT PERMANENTLY INSTALLED AS REQUIRED FOR EXECUTION OF THE SCOPE OF WORK.



Copyright © 2003 cre8 architects  
This document and the ideas and designs incorporated herein, as an instrument of professional service, is the property of cre8 architects and is not to be used, in whole or in part, for any project without the written authorization of cre8 architects.

# 2022 BOND - PAINTING PROJECT DISTRICTWIDE

3920 Mickey Gilley Boulevard  
Pasadena, Texas 77505

PASADENA INDEPENDENT SCHOOL DISTRICT



### Revision Schedule

NO.	ISSUE	DATE

Sheet Information

Date	29 April 2026
Job Number	25-007.2
Drawn	Author
Checked	Checker
Approved	Approver
	Title

### THE SUMMIT

Sheet  
**A2**

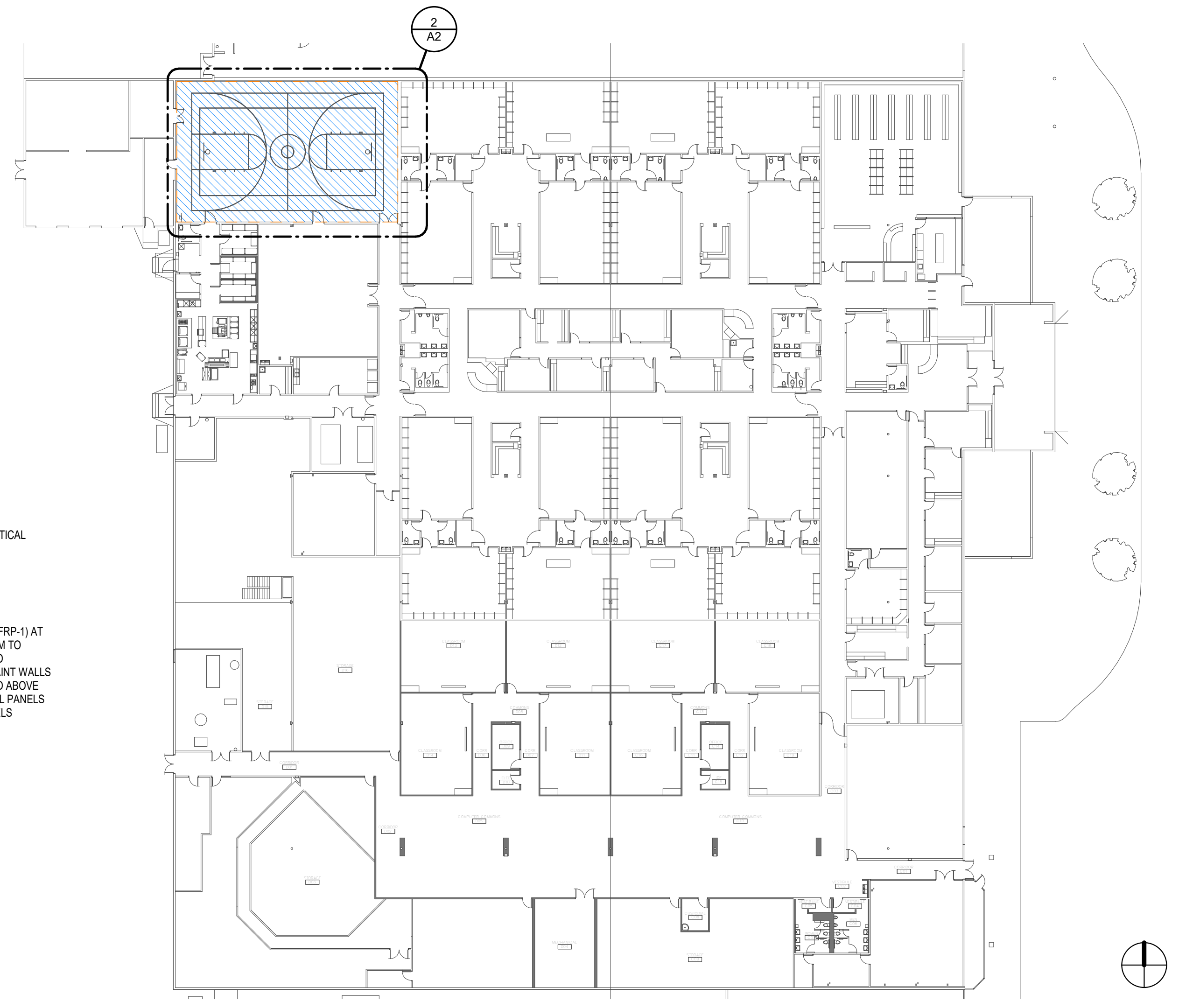

1 LEVEL 01 OVERALL FLOOR PLAN - THE SUMMIT  
1" = 30'-0"

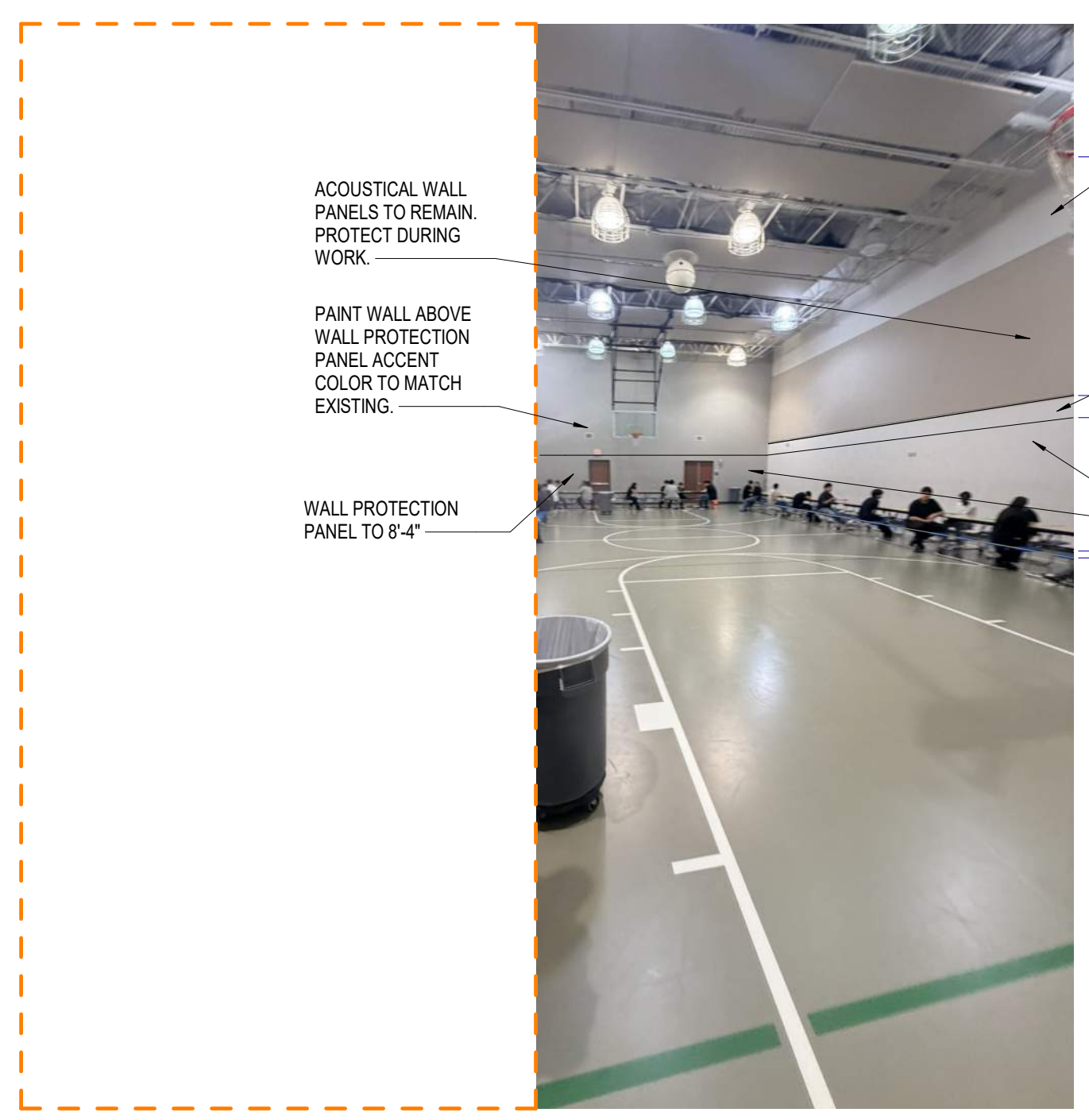

3 SUMMIT GYM  
1/4" = 1'-0"





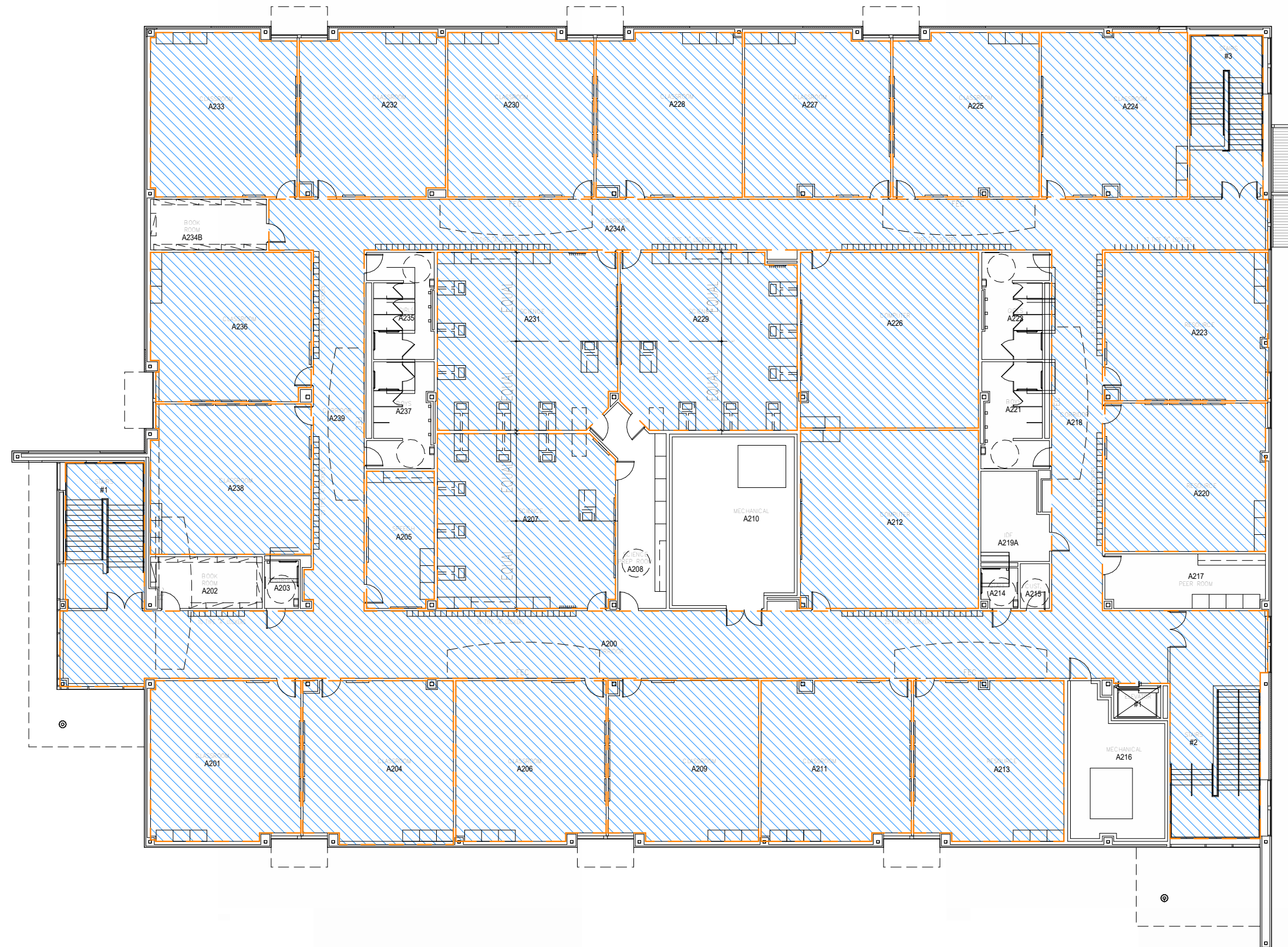

2 SHAW MIDDLE SCHOOL - FLOOR 2  
1" = 20'-0"

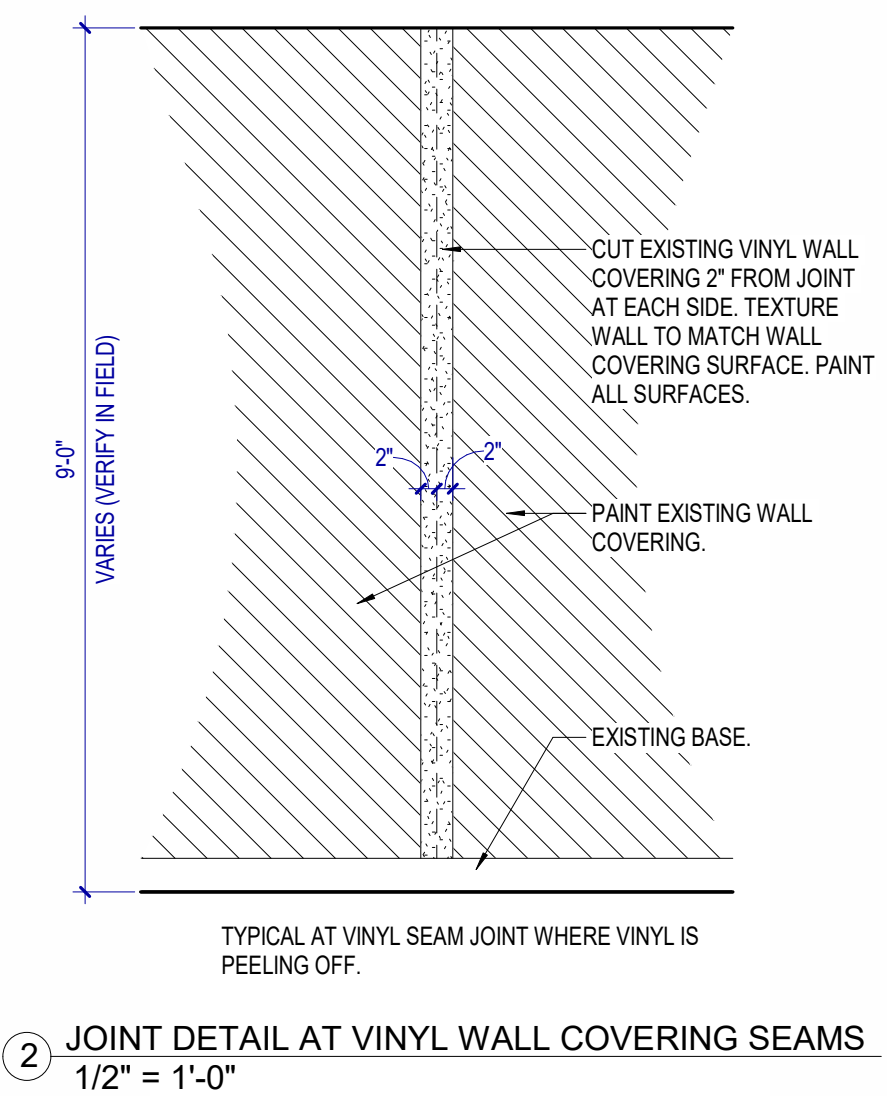

NOTES TO FINISH/COLOR SCHEDULE

**GENERAL NOTES**

- ALL NOTES ON THIS SHEET MAY NOT NECESSARILY BE USED.
- MANUFACTURER'S NAME AND IDENTIFICATION NUMBERS ARE LISTED AS A MEANS OF ESTABLISHING A STANDARD OF TYPE, FUNCTION, COLOR AND QUALITY. REFER TO SPECIFICATIONS FOR ADDITIONAL MANUFACTURERS AND PROCEDURES. ANY APPROVED MANUFACTURER'S COLORS SHALL MATCH THOSE LISTED IN THE COLOR SCHEDULE.
- THE CONTRACTOR SHALL SUBMIT TO THE ARCHITECT A SAMPLE OF ALL FINISH MATERIALS FOR APPROVAL BEFORE MATERIALS ARE APPLIED ON THE JOB.

**PAINTING AND STAINING NOTES**

- ALL PAINTS SHALL BE EGGSHELL FINISH, UNLESS NOTED OTHERWISE.
- PAINT A MINIMUM OF 6'-0" X 6'-0" OF EACH PAINT COLOR AT PROJECT SITE FOR OWNER/ARCHITECT APPROVAL PRIOR TO APPLICATION.
- UNLESS NOTED OTHERWISE, TERMINATE ALL ACCENT PAINTS AT INSIDE CORNERS.
- UNLESS NOTED OTHERWISE, PAINT ANY VENTS, GRILLES, FIRE EXTINGUISHER CABINETS, ETC. THE SAME COLOR AS THE WALL SURFACE ON WHICH THEY OCCUR.
- UNLESS NOTED OTHERWISE, PAINT ALL VISION PANEL FRAMES IN INTERIOR DOORS TO MATCH FRAME COLOR.
- PAINT ALL UNDESIGNATED GYPSUM BOARD CEILING WHITE UNLESS NOTED OTHERWISE.
- ACCESS PANELS SHALL BE PAINTED THE SAME COLOR AS THE ADJACENT SURFACE ON WHICH THEY OCCUR.
- NOT USED.
- UNLESS NOTED OTHERWISE, PAINT INTERIOR HM DOOR FRAMES P-3.
- UNLESS NOTED OTHERWISE, ALL CEILING ARE 9'-0".

P - PAINT			
TYPE	MARK	MANUFACTURER	COLOR
FIELD (WALL)	P-1	SHERWIN WILLIAMS	MATCH EXISTING
ACCENT (WALL)	P-2	SHERWIN WILLIAMS	MATCH EXISTING
HM FRAME	P-3	SHERWIN WILLIAMS	MATCH EXISTING
STAR STRINGERS AND KAILINGS	P-4	SHERWIN WILLIAMS	MATCH EXISTING

CG - CORNER GUARDS			
TYPE	MARK	MANUFACTURER	COLOR
ALL OUTSIDE CORNERS	CG-1	ACKROYVN	MATCH EXISTING (ABOVE BASE TO 7'-0" AFF)

**SCOPE OF WORK**

THE SCOPE OF WORK FOR THIS CAMPUS INCLUDES THE FOLLOWING:

- PREPARATION AND PAINTING OF WALL SURFACES IN MAIN AND SECONDARY BUILDING CORRIDORS (SHOWN IN BLUE).
- PREPARATION AND PAINTING OF WALL AS INDICATED IN BLUE.
- PREPARATION AND PAINTING OF STRINGERS AND HANDRAILS, TYPICAL ALL STAIRS DV.
- ALL GYPSUM BOARD PARTITIONS WITH WALLCOVERING, REPAIR EXISTING DAMAGED VINYL WALLCOVERING SEAMS AS INDICATED BY JOINT DETAIL 2/A4 PRIOR TO PAINTING OF THE WALLCOVERING SURFACE.
- PREPARATION AND PAINTING OF HOLLOW METAL DOOR AND WINDOW FRAMES.
- REMOVE ANY EXISTING CORNER GUARDS. INSTALL NEW CORNER GUARDS ON ALL OUTSIDE CORNERS TO 7'-0" AFF.
- PREPARATION AND PAINTING OF ANY VISION PANEL FRAMES IN DOORS.
- PREPARATION AND PAINTING OF DOOR SURFACES (IF PAINTED).
- RELOCATION OF MOVEABLE FURNISHINGS AND EQUIPMENT WITHIN ANY SPACE TO RECEIVE PAINT.

GENERAL NOTES

- MATCH EXISTING PAINT COLORS AT ALL LOCATIONS UNLESS NOTED OTHERWISE.
- PAINT WALLS TO INSIDE CORNERS.
- UNLESS NOTED OTHERWISE, TERMINATE ALL ACCENT PAINTS AT INSIDE CORNERS.
- UNLESS NOTE OTHERWISE, PAINT ANY VENTS, GRILLES, ETC. THE SAME COLOR AS THE WALL SURFACE ON WHICH THEY OCCUR.
- ACCESS PANELS SHALL BE PAINTED THE SAME COLOR AS THE ADJACENT SURFACE ON WHICH THEY OCCUR.
- CONTRACTOR TO FIELD VERIFY EXISTING CEILING HEIGHTS.
- PAINT ALL EXISTING HOLLOW METAL FRAMES.
- CONTRACTOR SHALL RELOCATE ROOM FURNISHINGS AND EQUIPMENT, STORE, AND OTHER ITEMS NOT PERMANENTLY INSTALLED AS REQUIRED FOR EXECUTION OF THE SCOPE OF WORK.

3815 Montrose Boulevard  
Suite 123  
Houston, Texas 77006  
713.526.cre8 (2738)  
713.526.3198 fax

Copyright © 2003 cre8 architects

This document and the ideas and designs incorporated herein, as an instrument of professional service, is the property of cre8 architects and is not to be used, in whole or in part, for any project without the written authorization of cre8 architects.

2022 BOND - PAINTING PROJECT  
DISTRICTWIDE

3920 Mickey Gilley Boulevard  
Pasadena, Texas 77505

PASADENA INDEPENDENT SCHOOL DISTRICT

LEGEND



1 SHAW MIDDLE SCHOOL - FLOOR 1  
1" = 20'-0"

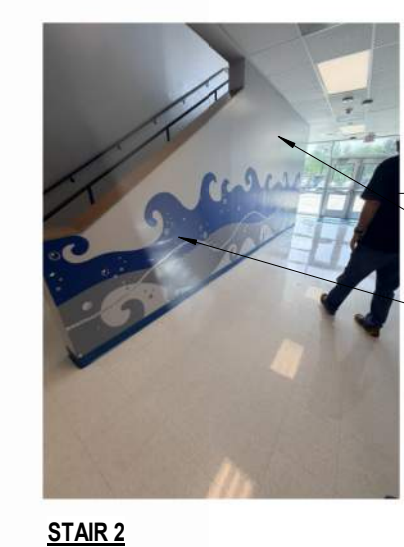
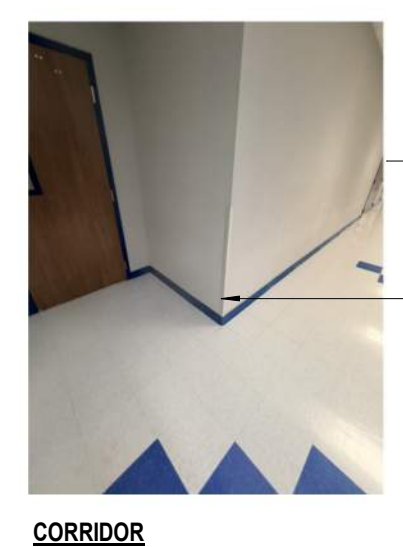
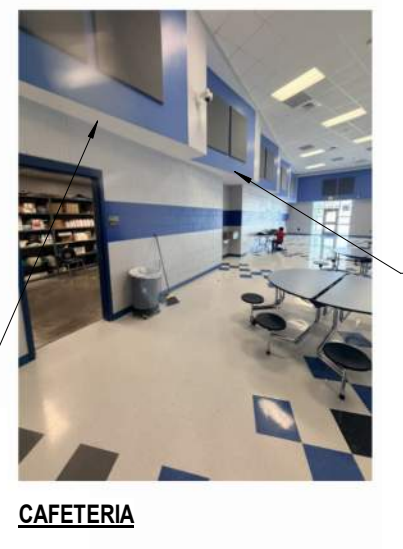
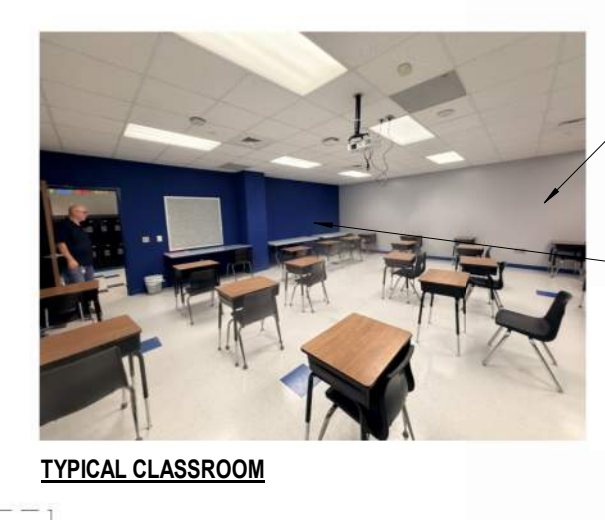
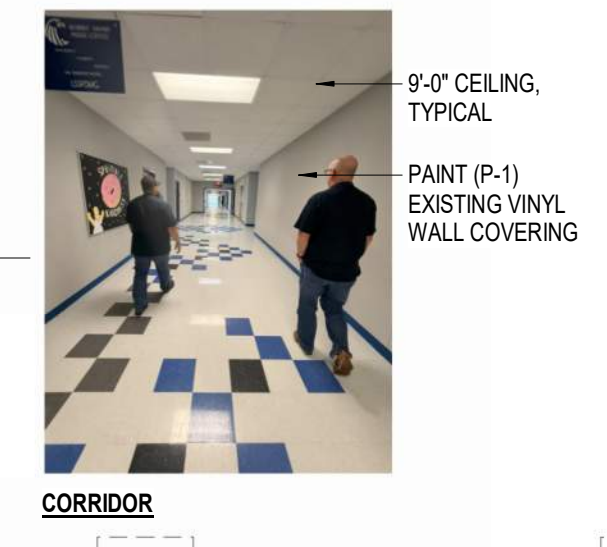

Revision Schedule		
NO.	ISSUE	DATE

Sheet Information		
Date	29 April 2026	
Job Number	25-007.2	
Drawn	Author	
Checked	Checker	
Approved	Approver	
		Title

BOBBY SHAW MIDDLE SCHOOL

Sheet  
**A5**

CONSTRUCTION DOCUMENTS







BINDING EDGE

BINDING EDGE

**SCOPE OF WORK**

THE SCOPE OF WORK FOR THIS CAMPUS INCLUDES THE FOLLOWING:

- PREPARATION AND PAINTING OF WALL SURFACES IN CLASSROOMS AND CLASSROOM CLOSETS. (SHOWN IN BLUE).
- PREPARATION AND PAINTING OF HOLLOW METAL DOOR AND WINDOW FRAMES.
- PREPARATION AND PAINTING OF ANY VISION PANEL FRAMES IN DOORS.
- PREPARATION AND PAINTING OF DOOR SURFACES (IF PAINTED).
- RELOCATION OF MOVEABLE FURNISHINGS AND EQUIPMENT WITHIN ANY SPACE TO RECEIVE PAINT.

**NOTES TO FINISH/COLOR SCHEDULE**

GENERAL NOTES

1. ALL NOTES ON THIS SHEET MAY NOT NECESSARILY BE USED.
2. MANUFACTURER'S NAME AND IDENTIFICATION NUMBERS ARE LISTED AS A MEANS OF ESTABLISHING A STANDARD OF TYPE, FUNCTION, COLOR AND QUALITY. REFER TO SPECIFICATIONS FOR ADDITIONAL MANUFACTURERS AND PROCEDURES. ANY APPROVED MANUFACTURER'S COLORS SHALL MATCH THOSE LISTED IN THE COLOR SCHEDULE.
3. THE CONTRACTOR SHALL SUBMIT TO THE ARCHITECT A SAMPLE OF ALL FINISH MATERIALS FOR APPROVAL BEFORE MATERIALS ARE APPLIED ON THE JOB.

PAINTING AND STAINING NOTES

1. ALL PAINTS SHALL BE EGGSHELL FINISH, UNLESS NOTED OTHERWISE.
2. PAINT A MINIMUM OF 6'-0" X 6'-0" OF EACH PAINT COLOR AT PROJECT SITE FOR OWNER/ARCHITECT APPROVAL PRIOR TO APPLICATION.
3. UNLESS NOTED OTHERWISE, TERMINATE ALL ACCENT PAINTS AT INSIDE CORNERS.
4. UNLESS NOTED OTHERWISE, PAINT ANY VENTS, GRILLES, FIRE EXTINGUISHER CABINETS, ETC. THE SAME COLOR AS THE WALL SURFACE ON WHICH THEY OCCUR.
5. UNLESS NOTED OTHERWISE, PAINT ALL VISION PANEL FRAMES IN INTERIOR DOORS TO MATCH FRAME COLOR.
6. NOT USED.
7. ACCESS PANELS SHALL BE PAINTED THE SAME COLOR AS THE ADJACENT SURFACE ON WHICH THEY OCCUR.
8. UNLESS NOTED OTHERWISE, REVEALS SHALL BE ALUMINUM FINISH.
9. UNLESS NOTED OTHERWISE, PAINT INTERIOR HM DOOR FRAMES P-3.
10. UNLESS NOTED OTHERWISE, CEILING HEIGHT IS 9'-0".

**GENERAL NOTES**

1. MATCH EXISTING PAINT COLORS AT ALL LOCATIONS UNLESS NOTED OTHERWISE.
2. PAINT WALLS TO INSIDE CORNERS.
3. UNLESS NOTED OTHERWISE, TERMINATE ALL ACCENT PAINTS AT INSIDE CORNERS.
4. UNLESS NOTE OTHERWISE, PAINT ANY VENTS, GRILLES, ETC. THE SAME COLOR AS THE WALL SURFACE ON WHICH THEY OCCUR.
5. ACCESS PANELS SHALL BE PAINTED THE SAME COLOR AS THE ADJACENT SURFACE ON WHICH THEY OCCUR.
6. CONTRACTOR TO FIELD VERIFY EXISTING CEILING HEIGHTS.
7. PAINT ALL EXISTING HOLLOW METAL FRAMES.
8. CONTRACTOR SHALL RELOCATE ROOM FURNISHINGS AND EQUIPMENT, STORE, AND OTHER ITEMS NOT PERMANENTLY INSTALLED AS REQUIRED FOR EXECUTION OF THE SCOPE OF WORK.

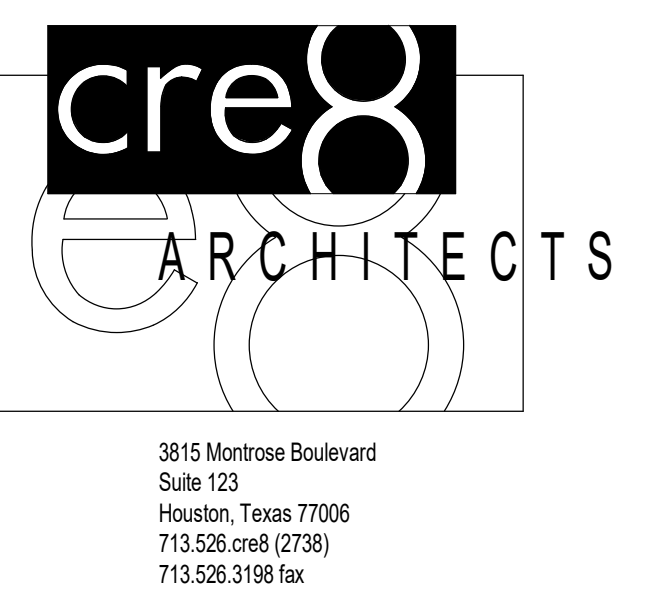

Copyright © 2003 cre8 architects  
 This document and the ideas and designs incorporated herein, as an instrument of professional service, is the property of cre8 architects and is not to be used, in whole or in part, for any project without the written authorization of cre8 architects.

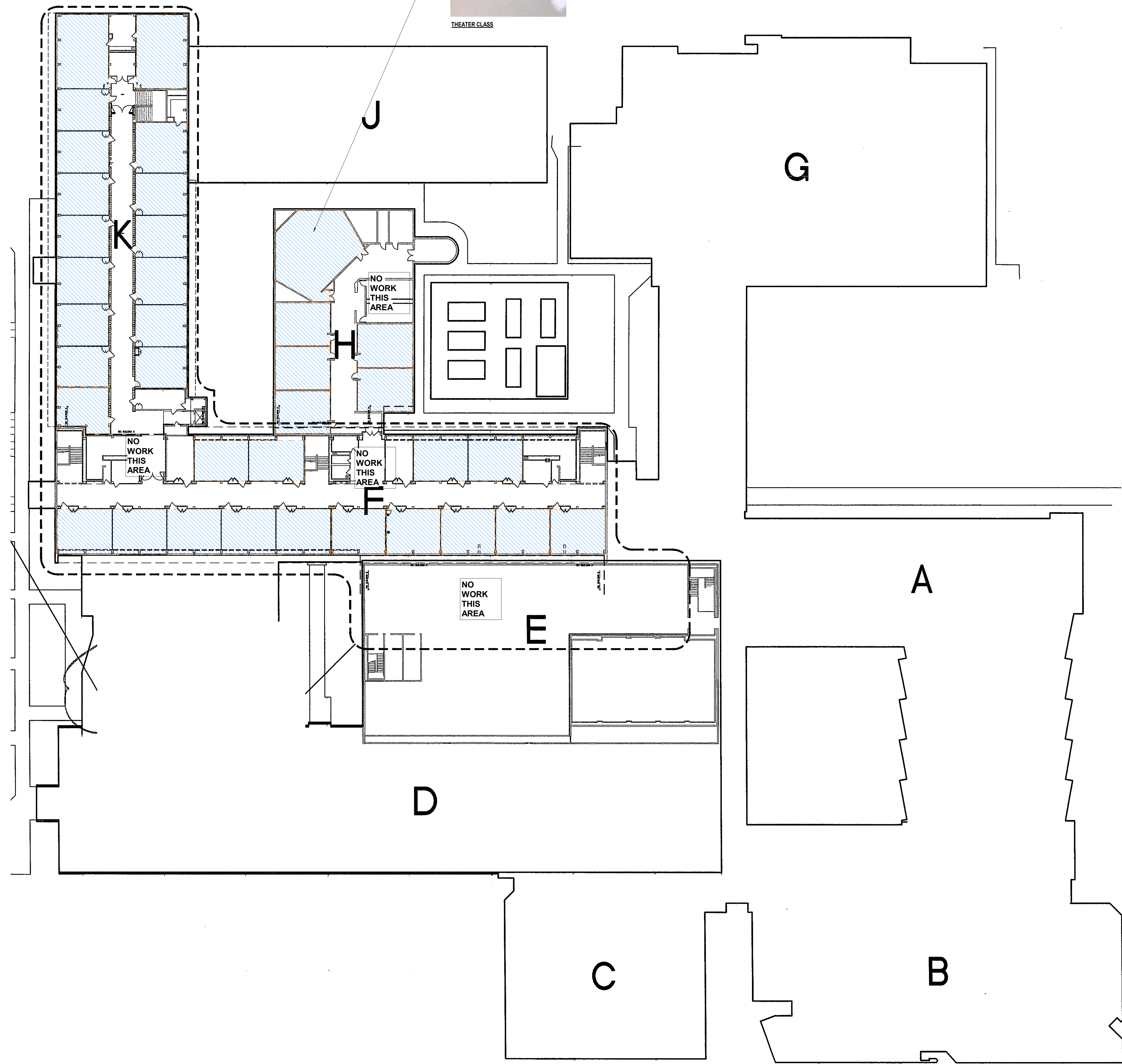
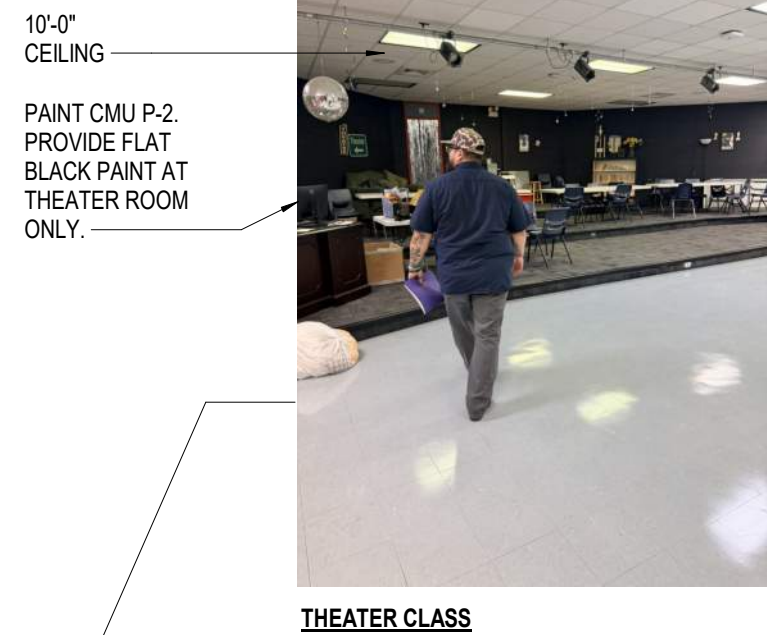

**P - PAINT**

TYPE	MARK	MANUFACTURER	COLOR
FIELD (WALL)	P-1	SHERWIN WILLIAMS	MATCH EXISTING
ACCENT	P-2	SHERWIN WILLIAMS	MATCH EXISTING
HM FRAME (BOTH SIDES)	P-3	SHERWIN WILLIAMS	MATCH EXISTING

**LEGEND**

AREA OF WORK

**2022 BOND - PAINTING PROJECT DISTRICTWIDE**

3920 Mickey Gilley Boulevard  
 Pasadena, Texas 77505

PASADENA INDEPENDENT SCHOOL DISTRICT



**Revision Schedule**

NO.	ISSUE	DATE

**Sheet Information**

Date	29 April 2026
Job Number	25-007.2
Drawn	Author
Checked	Checker
Approved	Approver
Title	

**SOUTH HOUSTON HIGH SCHOOL - LEVEL 2**

Sheet  
**A7.1**

CONSTRUCTION DOCUMENTS

# 2022 BOND - PAINTING PROJECT DISTRICTWIDE

## PACKAGE B

CSP No. 26P-040LP

### PASADENA INDEPENDENT SCHOOL DISTRICT

3920 Mickey Gilley Boulevard  
Pasadena, Texas 77505

29 April 2026

PACKAGE B CAMPUSES

**J. Frank Dobie High School**  
10220 Blackhawk Blvd.  
Houston, TX 77089

**Lonnie B. Keller Middle School**  
1711 Magnolia St.  
Pasadena, TX 77503

**Felix Morales Elementary School**  
305 W Harris Ave.  
Pasadena, TX 77506

**Pasadena Memorial High School**  
4410 Crenshaw Rd.  
Pasadena, TX 77504

**Mathys Elementary School**  
500 Main St.  
South Houston, TX 77587

INDEX OF DRAWINGS - PACKAGE B	
Sheet Number	Sheet Name
00 GENERAL SHEETS	
B0.00	COVERSHEET - PACKAGE B
02 PACKAGE B	
B1	DOBIE HIGH SCHOOL - LEVEL 1
B1.1	DOBIE HIGH SCHOOL - LEVEL 2
B2	KELLER MIDDLE SCHOOL - LEVEL 1
B2.1	KELLER MIDDLE SCHOOL - LEVEL 2
B3	MORALES ELEMENTARY SCHOOL
B4	PASADENA MEMORIAL HIGH SCHOOL - LEVEL 1
B4.1	PASADENA MEMORIAL HIGH SCHOOL LEVEL - 2
B5	MATHYS ELEMENTARY SCHOOL

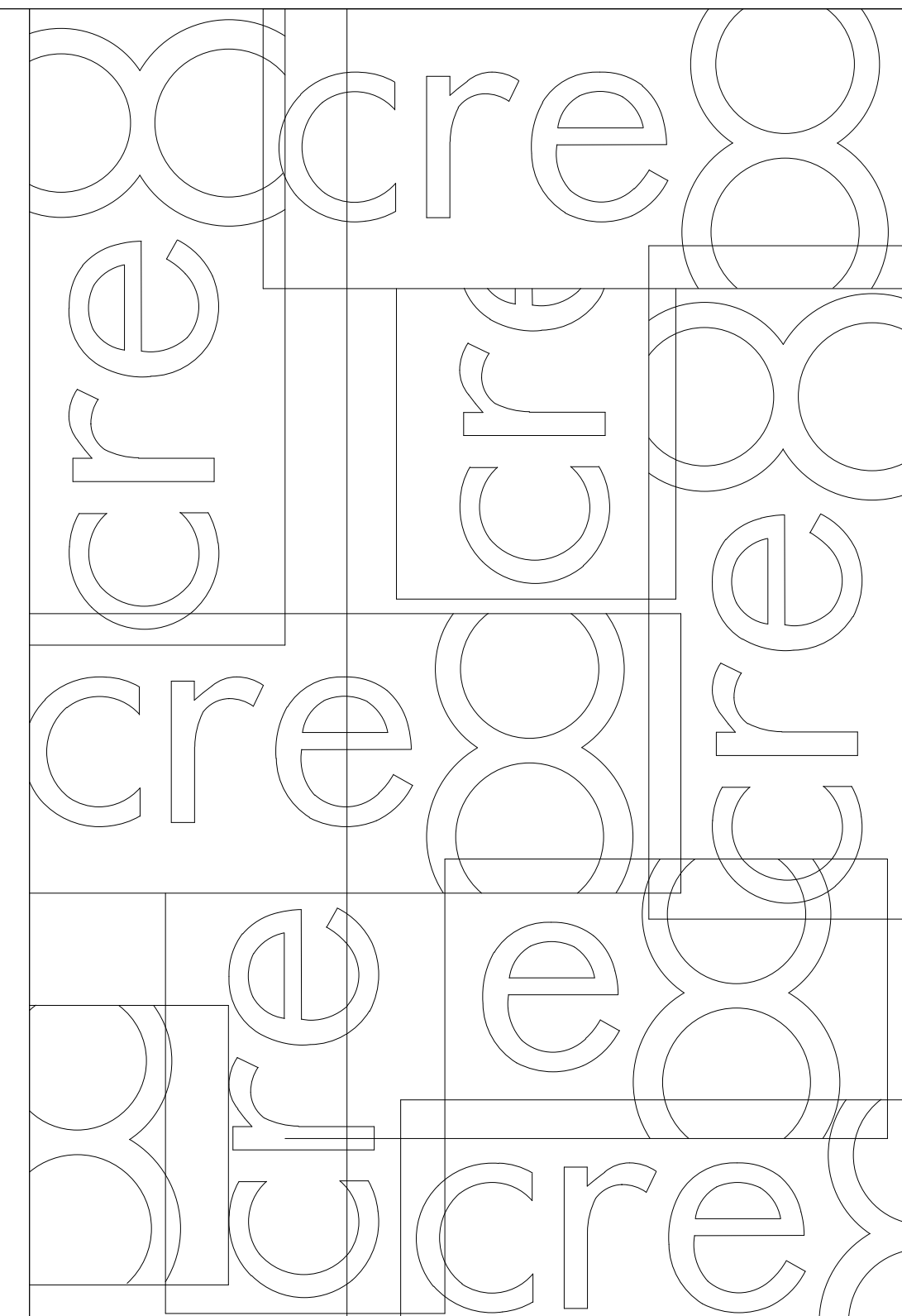

## ARCHITECT

3815 Montrose Boulevard  
Suite 123  
Houston, Texas 77006  
713.526.cre8 (2738)  
713.526.3198 fax

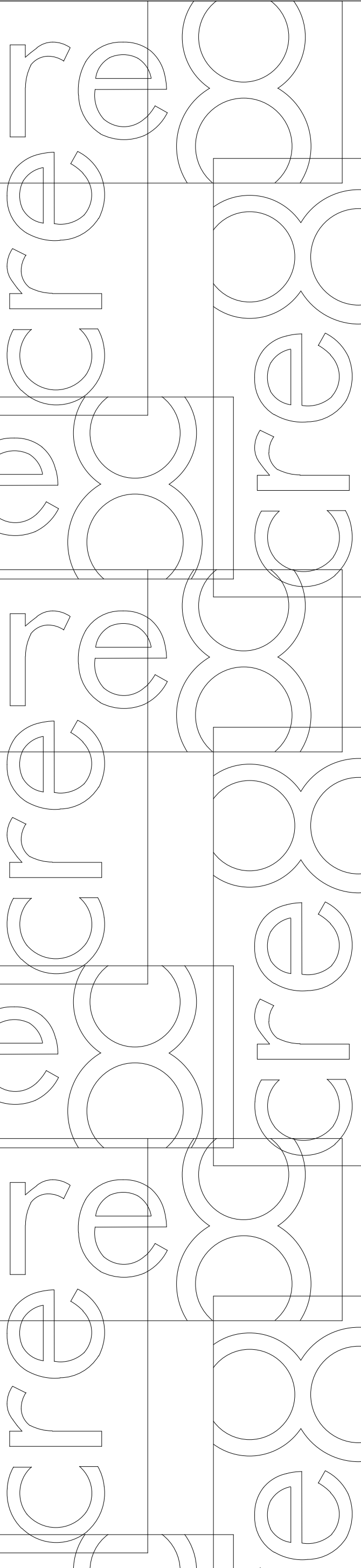



### NOTES TO FINISH/COLOR SCHEDULE

- GENERAL NOTES**
- ALL NOTES ON THIS SHEET MAY NOT NECESSARILY BE USED.
  - MANUFACTURER'S NAME AND IDENTIFICATION NUMBERS ARE LISTED AS A MEANS OF ESTABLISHING A STANDARD OF TYPE, FUNCTION, COLOR AND QUALITY. REFER TO SPECIFICATIONS FOR ADDITIONAL MANUFACTURERS AND PROCEDURES. ANY APPROVED MANUFACTURER'S COLORS SHALL MATCH THOSE LISTED IN THE COLOR SCHEDULE.
  - THE CONTRACTOR SHALL SUBMIT TO THE ARCHITECT A SAMPLE OF ALL FINISH MATERIALS FOR APPROVAL BEFORE MATERIALS ARE APPLIED ON THE JOB.

- PAINTING AND STAINING NOTES**
- ALL PAINTS SHALL BE EGGSHELL FINISH, UNLESS NOTED OTHERWISE.
  - PAINT A MINIMUM OF 6'-0" X 6'-0" OF EACH PAINT COLOR AT PROJECT SITE FOR OWNER/ARCHITECT APPROVAL PRIOR TO APPLICATION.
  - UNLESS NOTED OTHERWISE, TERMINATE ALL ACCENT PAINTS AT INSIDE CORNERS.
  - UNLESS NOTED OTHERWISE, PAINT ANY VENTS, GRILLES, FIRE EXTINGUISHER CABINETS, ETC. THE SAME COLOR AS THE WALL SURFACE ON WHICH THEY OCCUR.
  - UNLESS NOTED OTHERWISE, PAINT ALL VISION PANEL FRAMES IN INTERIOR DOORS TO MATCH FRAME COLOR.
  - NOT USED.
  - ACCESS PANELS SHALL BE PAINTED THE SAME COLOR AS THE ADJACENT SURFACE ON WHICH THEY OCCUR.
  - NOT USED.
  - UNLESS NOTED OTHERWISE, PAINT INTERIOR HM DOOR & WINDOW FRAMES P-3.
  - UNLESS NOTED OTHERWISE, ALL CEILINGS ARE 9'-0". VERIFY IN FIELD.

**P - PAINT**

TYPE	MARK	MANUFACTURER	COLOR
FIELD WALL	P-1	SHERWIN WILLIAMS	MATCH EXISTING
ACCENT WALL	P-2	SHERWIN WILLIAMS	MATCH EXISTING
HM FRAME	P-3	SHERWIN WILLIAMS	MATCH EXISTING

### SCOPE OF WORK

- THE SCOPE OF WORK FOR THIS CAMPUS INCLUDES THE FOLLOWING:
- PREPARE AND SKIM COAT ALL DRYWALL SURFACES AS REQUIRED TO CREATE SMOOTH AND UNIFORM SURFACE FOR NEW PAINT APPLICATION.
  - PREPARATION AND PAINTING OF WALL SURFACES IN CLASSROOMS. (SHOWN IN BLUE)
  - PREPARATION AND PAINTING OF HOLLOW METAL DOOR AND WINDOW FRAMES.
  - PREPARATION AND PAINTING OF ANY VISION PANEL FRAMES IN DOORS.
  - RELOCATION OF MOVEABLE FURNISHINGS AND EQUIPMENT WITHIN ANY SPACE TO RECEIVE PAINT.

### GENERAL NOTES

- MATCH EXISTING PAINT COLORS AT ALL LOCATIONS UNLESS NOTED OTHERWISE.
- PAINT WALLS TO INSIDE CORNERS.
- UNLESS NOTED OTHERWISE, TERMINATE ALL ACCENT PAINTS AT INSIDE CORNERS.
- UNLESS NOTE OTHERWISE, PAINT ANY VENTS, GRILLES, ETC. THE SAME COLOR AS THE WALL SURFACE ON WHICH THEY OCCUR.
- ACCESS PANELS SHALL BE PAINTED THE SAME COLOR AS THE ADJACENT SURFACE ON WHICH THEY OCCUR.
- CONTRACTOR TO FIELD VERIFY EXISTING CEILING HEIGHTS.
- PAINT ALL EXISTING HOLLOW METAL FRAMES.
- CONTRACTOR SHALL RELOCATE ROOM FURNISHINGS AND EQUIPMENT, STORE, AND OTHER ITEMS NOT PERMANENTLY INSTALLED AS REQUIRED FOR EXECUTION OF THE SCOPE OF WORK.

### LEGEND

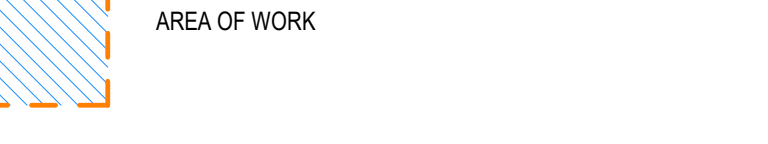

This document and the ideas and designs incorporated herein, as an instrument of professional service, is the property of cre8 architects and is not to be used, in whole or in part, for any project without the written authorization of cre8 architects.

# 2022 BOND - PAINTING PROJECT DISTRICTWIDE

3920 Mickey Gilley Boulevard  
Pasadena, Texas 77505

PASADENA INDEPENDENT SCHOOL DISTRICT



**Revision Schedule**

NO.	ISSUE	DATE

**Sheet Information**

Date	29 April 2026
Job Number	25-007.2
Drawn	Author
Checked	Checker
Approved	Approver
	Title

**DOBIE HIGH SCHOOL - LEVEL 1**

Sheet  
**B1**

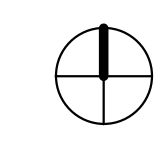



1 DOBIE HIGH SCHOOL FLOOR 2  
1" = 30'-0"

**NOTES TO FINISH/COLOR SCHEDULE**

- GENERAL NOTES**
- ALL NOTES ON THIS SHEET MAY NOT NECESSARILY BE USED.
  - MANUFACTURER'S NAME AND IDENTIFICATION NUMBERS ARE LISTED AS A MEANS OF ESTABLISHING A STANDARD OF TYPE, FUNCTION, COLOR AND QUALITY. REFER TO SPECIFICATIONS FOR ADDITIONAL MANUFACTURERS AND PROCEDURES. ANY APPROVED MANUFACTURER'S COLORS SHALL MATCH THOSE LISTED IN THE COLOR SCHEDULE.
  - THE CONTRACTOR SHALL SUBMIT TO THE ARCHITECT A SAMPLE OF ALL FINISH MATERIALS FOR APPROVAL BEFORE MATERIALS ARE APPLIED ON THE JOB.

- PAINTING AND STAINING NOTES**
- ALL PAINTS SHALL BE EGGSHELL FINISH, UNLESS NOTED OTHERWISE. PAINT A MINIMUM OF 6'-0" X 6'-0" OF EACH PAINT COLOR AT PROJECT SITE FOR OWNER/ARCHITECT APPROVAL PRIOR TO APPLICATION UNLESS NOTED OTHERWISE, TERMINATE ALL ACCENT PAINTS AT INSIDE CORNERS.
  - UNLESS NOTED OTHERWISE, PAINT ANY VENTS, GRILLES, FIRE EXTINGUISHER CABINETS, ETC. THE SAME COLOR AS THE WALL SURFACE ON WHICH THEY OCCUR.
  - UNLESS NOTED OTHERWISE, PAINT ALL VISION PANEL FRAMES IN INTERIOR DOORS TO MATCH FRAME COLOR.
  - NOT USED.
  - ACCESS PANELS SHALL BE PAINTED THE SAME COLOR AS THE ADJACENT SURFACE ON WHICH THEY OCCUR.
  - NOT USED.
  - UNLESS NOTED OTHERWISE, PAINT INTERIOR HM DOOR & WINDOW FRAMES P-3.
  - UNLESS NOTED OTHERWISE, ALL CEILINGS ARE 9'-0". VERIFY IN FIELD.

**P - PAINT**

TYPE	MARK	MANUFACTURER	COLOR
FIELD WALL	P-1	SHERWIN WILLIAMS	MATCH EXISTING
ACCENT WALL	P-2	SHERWIN WILLIAMS	MATCH EXISTING
HM FRAME	P-3	SHERWIN WILLIAMS	MATCH EXISTING

**SCOPE OF WORK**

- THE SCOPE OF WORK FOR THIS CAMPUS INCLUDES THE FOLLOWING:
- PREPARE AND SKIM COAT ALL DRYWALL SURFACES AS REQUIRED TO CREATE SMOOTH AND UNIFORM SURFACE FOR NEW PAINT APPLICATION.
  - PREPARATION AND PAINTING OF WALL SURFACES IN CLASSROOMS. (SHOWN IN BLUE)
  - PREPARATION AND PAINTING OF HOLLOW METAL DOOR AND WINDOW FRAMES.
  - PREPARATION AND PAINTING OF ANY VISION PANEL FRAMES IN DOORS.
  - RELOCATION OF MOVEABLE FURNISHINGS AND EQUIPMENT WITHIN ANY SPACE TO RECEIVE PAINT.

**GENERAL NOTES**

- MATCH EXISTING PAINT COLORS AT ALL LOCATIONS UNLESS NOTED OTHERWISE.
- PAINT WALLS TO INSIDE CORNERS.
- UNLESS NOTED OTHERWISE, TERMINATE ALL ACCENT PAINTS AT INSIDE CORNERS.
- UNLESS NOTED OTHERWISE, PAINT ANY VENTS, GRILLES, ETC. THE SAME COLOR AS THE WALL SURFACE ON WHICH THEY OCCUR.
- ACCESS PANELS SHALL BE PAINTED THE SAME COLOR AS THE ADJACENT SURFACE ON WHICH THEY OCCUR.
- CONTRACTOR TO FIELD VERIFY EXISTING CEILING HEIGHTS.
- PAINT ALL EXISTING HOLLOW METAL FRAMES.
- CONTRACTOR SHALL RELOCATE ROOM FURNISHINGS AND EQUIPMENT, STORE, AND OTHER ITEMS NOT PERMANENTLY INSTALLED AS REQUIRED FOR EXECUTION OF THE SCOPE OF WORK.



Copyright © 2003 cre8 architects  
This document and the ideas and designs incorporated herein, as an instrument of professional service, is the property of cre8 architects and is not to be used, in whole or in part, for any project without the written authorization of cre8 architects.

**LEGEND**

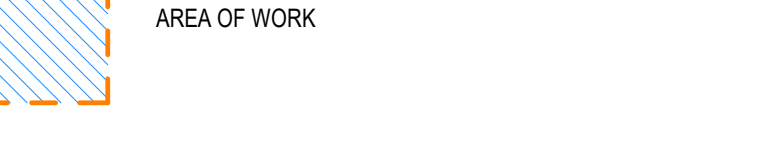

**2022 BOND - PAINTING PROJECT  
DISTRICTWIDE**  
3920 Mickey Gilley Boulevard  
Pasadena, Texas 77505  
PASADENA INDEPENDENT SCHOOL DISTRICT



**Revision Schedule**

NO.	ISSUE	DATE

**Sheet Information**

Date	29 April 2026
Job Number	25-007.2
Drawn	Author
Checked	Checker
Approved	Approver
	Title

**DOBIE HIGH SCHOOL - LEVEL 2**

Sheet  
**B1.1**  
CONSTRUCTION DOCUMENTS



### NOTES TO FINISH/COLOR SCHEDULE

- GENERAL NOTES**
- ALL NOTES ON THIS SHEET MAY NOT NECESSARILY BE USED.
  - MANUFACTURER'S NAME AND IDENTIFICATION NUMBERS ARE LISTED AS A MEANS OF ESTABLISHING A STANDARD OF TYPE, FUNCTION, COLOR AND QUALITY. REFER TO SPECIFICATIONS FOR ADDITIONAL MANUFACTURERS AND PROCEDURES. ANY APPROVED MANUFACTURER'S COLORS SHALL MATCH THOSE LISTED IN THE COLOR SCHEDULE.
  - THE CONTRACTOR SHALL SUBMIT TO THE ARCHITECT A SAMPLE OF ALL FINISH MATERIALS FOR APPROVAL BEFORE MATERIALS ARE APPLIED ON THE JOB.

- PAINTING AND STAINING NOTES**
- ALL PAINTS SHALL BE EGGSHELL FINISH, UNLESS NOTED OTHERWISE.
  - PAIN A MINIMUM OF 6" X 6" OF EACH PAINT COLOR AT PROJECT SITE FOR OWNER/ARCHITECT APPROVAL PRIOR TO APPLICATION.
  - UNLESS NOTED OTHERWISE, TERMINATE ALL ACCENT PAINTS AT INSIDE CORNERS.
  - UNLESS NOTED OTHERWISE, PAINT ANY VENTS, GRILLES, FIRE EXTINGUISHER CABINETS, ETC. THE SAME COLOR AS THE WALL SURFACE ON WHICH THEY OCCUR.
  - UNLESS NOTED OTHERWISE, PAINT ALL VISION PANEL FRAMES IN INTERIOR DOORS TO MATCH FRAME COLOR.
  - NOT USED.
  - ACCESS PANELS SHALL BE PAINTED THE SAME COLOR AS THE ADJACENT SURFACE ON WHICH THEY OCCUR.
  - UNLESS NOTED OTHERWISE, REVEALS SHALL BE ALUMINUM FINISH.
  - UNLESS NOTED OTHERWISE, PAINT INTERIOR HM DOOR FRAMES P-3.

**P - PAINT**

TYPE	MARK	MANUFACTURER	COLOR
FIELD (WALL)	P-1	SHERWIN WILLIAMS	MATCH EXISTING
ACCENT	P-2	SHERWIN WILLIAMS	MATCH EXISTING
BACK STAGE	P-3A	SHERWIN WILLIAMS	TRICORN BLACK - SW 6258 (MATTE FINISH)
HM FRAME	P-3	SHERWIN WILLIAMS	MATCH EXISTING

**WT - WAINSCOT PANEL**

TYPE	MARK	MANUFACTURER	SIZE	COLOR
FIELD WALL	WT-1	ACROVYN WAINSCOT PANEL	36" HIGH	EGGSHELL # 100
ACCENT WALL	WT-1A	ACROVYN WAINSCOT PANEL	36" HIGH	SLATE #209

### SCOPE OF WORK

- THE SCOPE OF WORK FOR THIS CAMPUS INCLUDES THE FOLLOWING:
- PREPARE AND SKIM COAT ALL DRYWALL SURFACES AS REQUIRED TO CREATE SMOOTH AND UNIFORM SURFACE FOR NEW PAINT APPLICATION.
  - PREPARATION AND PAINTING OF WALL SURFACES IN CLASSROOMS (SHOWN IN BLUE).
  - REPAIR AND PAINT DAMAGED WALL SURFACES IN MAIN STREET CORRIDOR AND EAST WALL OF DINING.
  - PREPARATION AND PAINTING OF HOLLOW METAL DOOR AND WINDOW FRAMES.
  - PREPARATION AND PAINTING OF STRINGERS AND HANDRAILS, TYPICAL ALL STAIRS.
  - PREPARATION AND PAINTING OF ANY VISION PANEL FRAMES IN DOORS.
  - PROVIDE WAINSCOT PANEL AT SCIENCE ROOMS. START PANELS AT TOP OF BASE AND EXTENDS TO 36" ABOVE FINISH FLOOR. FLOAT SMOOTH AND PREPARE WALL PRIOR TO INSTALLING WAINSCOT PANELS.
  - RELOCATION OF MOVEABLE FURNISHINGS AND EQUIPMENT WITHIN ANY SPACE TO RECEIVE PAINT.

### GENERAL NOTES

- MATCH EXISTING PAINT COLORS AT ALL LOCATIONS UNLESS NOTED OTHERWISE.
- PAINT WALLS TO INSIDE CORNERS.
- UNLESS NOTED OTHERWISE, TERMINATE ALL ACCENT PAINTS AT INSIDE CORNERS.
- UNLESS NOTE OTHERWISE, PAINT ANY VENTS, GRILLES, ETC. THE SAME COLOR AS THE WALL SURFACE ON WHICH THEY OCCUR.
- ACCESS PANELS SHALL BE PAINTED THE SAME COLOR AS THE ADJACENT SURFACE ON WHICH THEY OCCUR.
- CONTRACTOR TO FIELD VERIFY EXISTING CEILING HEIGHTS.
- PAINT ALL EXISTING HOLLOW METAL FRAMES.
- CONTRACTOR SHALL RELOCATE ROOM FURNISHINGS AND EQUIPMENT, STORE, AND OTHER ITEMS NOT PERMANENTLY INSTALLED AS REQUIRED FOR EXECUTION OF THE SCOPE OF WORK.



Copyright © 2003 cre8 architects  
 This document and the ideas and designs incorporated herein, as an instrument of professional service, is the property of cre8 architects and is not to be used, in whole or in part, for any project without the written authorization of cre8 architects.

# 2022 BOND - PAINTING PROJECT DISTRICTWIDE

3920 Mickey Gilley Boulevard  
Pasadena, Texas 77505

PASADENA INDEPENDENT SCHOOL DISTRICT

### LEGEND

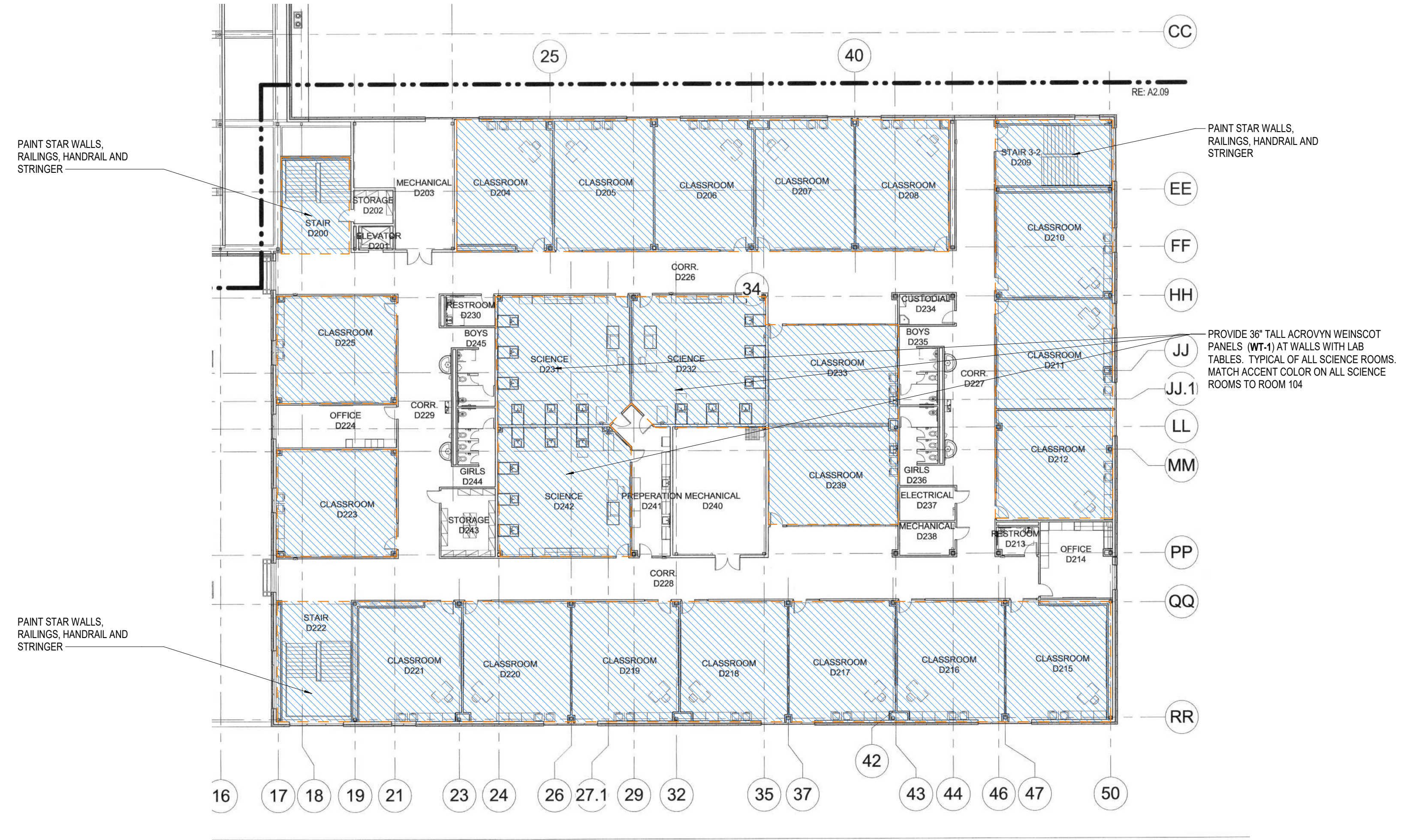
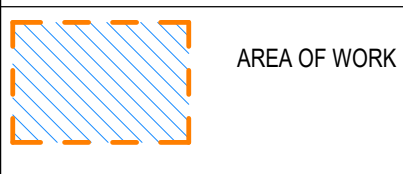

1 KELLER MIDDLE SCHOOL - FLOOR 2  
1" = 20'-0"



Revision Schedule

NO.	ISSUE	DATE

Sheet Information

Date	29 April 2026
Job Number	25-007.2
Drawn	Author
Checked	Checker
Approved	Approver
	Title

KELLER MIDDLE SCHOOL - LEVEL 2

Sheet  
**B2.1**  
CONSTRUCTION DOCUMENTS







### SCOPE OF WORK

- THE SCOPE OF WORK FOR THIS CAMPUS INCLUDES THE FOLLOWING:
- PREPARATION AND PAINTING OF WALL SURFACES IN CLASSROOM PODS, CLASSROOMS, MAIN AND SECONDARY BUILDING CORRIDORS (SHOWN IN BLUE).
  - PREPARATION AND PAINTING OF WALL SURFACES IN LIBRARY
  - ALL GYPSUM BOARD PARTITIONS WITH WALLCOVERING, REPAIR EXISTING DAMAGED VINYL WALLCOVERING SEAMS AS INDICATED BY JOINT DETAIL 2B5 PRIOR TO PAINTING OF THE WALLCOVERING SURFACE.
  - PREPARATION AND PAINTING OF HOLLOW METAL DOOR AND WINDOW FRAMES
  - PREPARATION AND PAINTING OF ANY VISION PANEL FRAMES IN DOORS
  - PREPARATION AND PAINTING OF DOOR SURFACES (IF PAINTED)
  - RELOCATION OF MOVEABLE FURNISHINGS AND EQUIPMENT WITHIN ANY SPACE TO RECEIVE PAINT

### NOTES TO FINISH/COLOR SCHEDULE

- GENERAL NOTES
1. ALL NOTES ON THIS SHEET MAY NOT NECESSARILY BE USED.
  2. MANUFACTURER'S NAME AND IDENTIFICATION NUMBERS ARE LISTED AS A MEANS OF ESTABLISHING A STANDARD OF TYPE, FUNCTION, COLOR AND QUALITY. REFER TO SPECIFICATIONS FOR ADDITIONAL MANUFACTURERS AND PROCEDURES. ANY APPROVED MANUFACTURER'S COLORS SHALL MATCH THOSE LISTED IN THE COLOR SCHEDULE.
  3. THE CONTRACTOR SHALL SUBMIT TO THE ARCHITECT A SAMPLE OF ALL FINISH MATERIALS FOR APPROVAL BEFORE MATERIALS ARE APPLIED ON THE JOB.

- PAINTING AND STAINING NOTES
1. ALL PAINTS SHALL BE EGGSHELL FINISH, UNLESS NOTED OTHERWISE.
  2. PAINT A MINIMUM OF 6'-0" X 6'-0" OF EACH PAINT COLOR AT PROJECT SITE FOR OWNER/ARCHITECT APPROVAL PRIOR TO APPLICATION.
  3. UNLESS NOTED OTHERWISE, TERMINATE ALL ACCENT PAINTS AT INSIDE CORNERS.
  4. UNLESS NOTED OTHERWISE, PAINT ANY VENTS, GRILLES, FIRE EXTINGUISHER CABINETS, ETC. THE SAME COLOR AS THE WALL SURFACE ON WHICH THEY OCCUR.
  5. UNLESS NOTED OTHERWISE, PAINT ALL VISION PANEL FRAMES IN INTERIOR DOORS TO MATCH FRAME COLOR.
  6. PAINT ALL UNDESIGNATED GYPSUM BOARD CEILINGS WHITE, UNLESS NOTED OTHERWISE.
  7. ACCESS PANELS SHALL BE PAINTED THE SAME COLOR AS THE ADJACENT SURFACE ON WHICH THEY OCCUR.
  8. UNLESS NOTED OTHERWISE, REVEALS SHALL BE ALUMINUM FINISH.
  9. UNLESS NOTED OTHERWISE, PAINT INTERIOR HM DOOR FRAMES P-3.
  10. UNLESS NOTED OTHERWISE CLASSROOM CEILINGS ARE AT 9'-0" AND CORRIDORS ARE AT 10'-0". VERIFY IN FIELD.

P - PAINT			
TYPE	MARK	MANUFACTURER	COLOR
FIELD (WALL)	P-1	SHERWIN WILLIAMS	MATCH EXISTING
ACCENT	P-2	SHERWIN WILLIAMS	MATCH EXISTING
HM FRAME	P-3	SHERWIN WILLIAMS	MATCH EXISTING

### GENERAL NOTES

1. MATCH EXISTING PAINT COLORS AT ALL LOCATIONS UNLESS NOTED OTHERWISE.
2. PAINT WALLS TO INSIDE CORNERS.
3. UNLESS NOTED OTHERWISE, TERMINATE ALL ACCENT PAINTS AT INSIDE CORNERS.
4. UNLESS NOTE OTHERWISE, PAINT ANY VENTS, GRILLES, ETC. THE SAME COLOR AS THE WALL SURFACE ON WHICH THEY OCCUR.
5. ACCESS PANELS SHALL BE PAINTED THE SAME COLOR AS THE ADJACENT SURFACE ON WHICH THE OCCUR.
6. CONTRACTOR TO FIELD VERIFY EXISTING CEILING HEIGHTS.
7. PAINT ALL EXISTING HOLLOW METAL FRAMES.
8. CONTRACTOR SHALL RELOCATE ROOM FURNISHINGS AND EQUIPMENT, STORE, AND OTHER ITEMS NOT PERMANENTLY INSTALLED AS REQUIRED FOR EXECUTION OF THE SCOPE OF WORK.

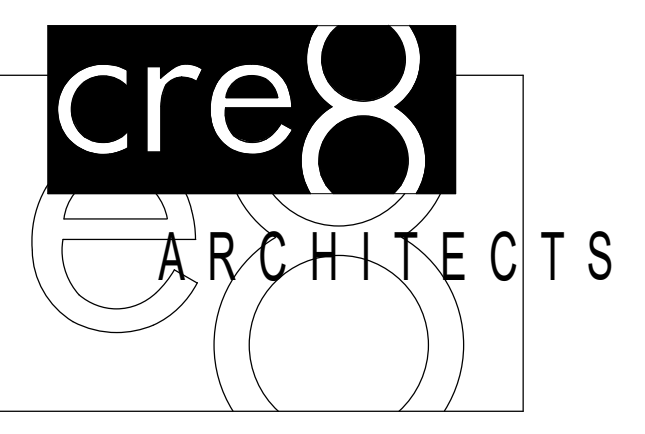

3815 Montrose Boulevard  
Suite 123  
Houston, Texas 77006  
713.526.cre8 (2738)  
713.526.3198 fax

Copyright © 2003 cre8 architects  
This document and the ideas and designs incorporated herein, as an instrument of professional service, is the property of cre8 architects and is not to be used, in whole or in part, for any project without the written authorization of cre8 architects.

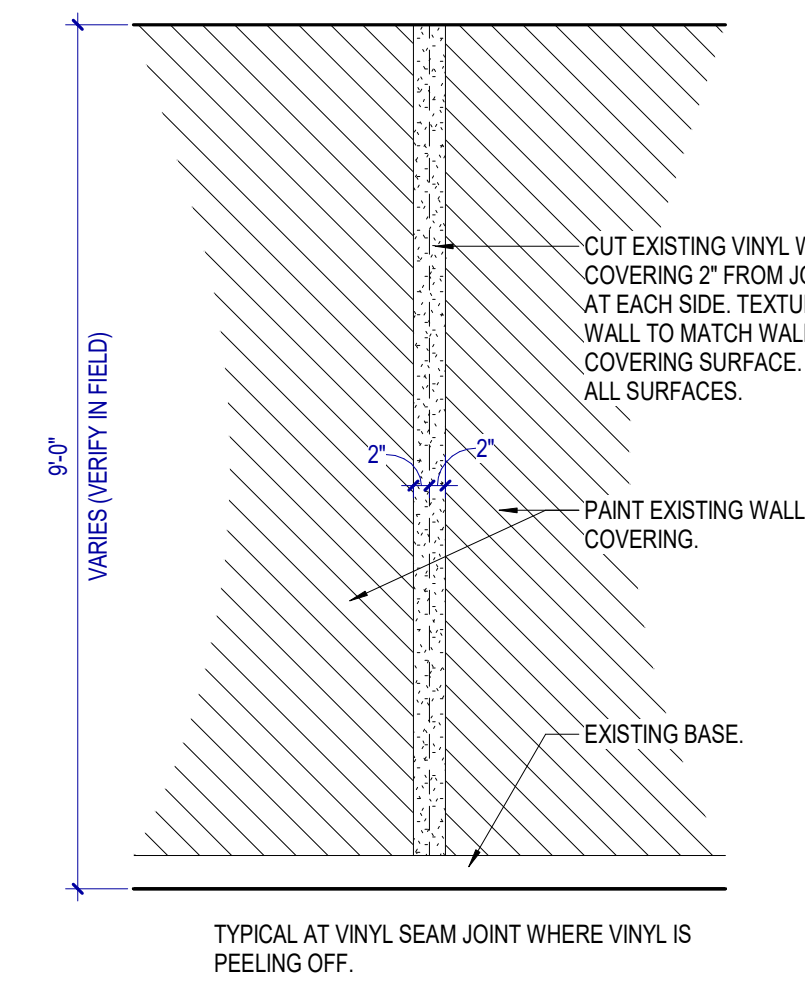

2  
JOINT DETAIL AT VINYL WALL COVERING SEAMS  
1/2" = 1'-0"



### LEGEND

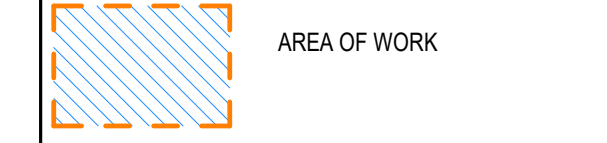

**2022 BOND - PAINTING PROJECT**  
**DISTRICTWIDE**  
 3920 Mickey Gilley Boulevard  
 Pasadena, Texas 77505  
 PASADENA INDEPENDENT SCHOOL DISTRICT



Revision Schedule		
NO.	ISSUE	DATE

Sheet Information	
Date	29 April 2026
Job Number	25-007.2
Drawn	Author
Checked	Checker
Approved	Approver
	Title

**MATHYS  
ELEMENTARY  
SCHOOL**

Sheet  
**B5**

1 MATHYS ELEMENTARY SCHOOL - FLOOR PLAN  
1" = 20'-0"